

DEA Marine

Marintec 2021
DMG-MAR-21-12



✓ RÅDGIVNING ✓ DESIGN ✓ HÅNDVÆRK ✓ TEKNOLOGI



 <div>Standesign A/S Alsvej 2F 5800 Nyborg Denmark Phone: +45 4484 6699</div>
<div>Project nr.: DMG-MAR-21-12 Drawing nr.: 3D-001 Drawing name: Bird View 1 Designed by: TCH / SFT Hall: - Booth: -</div> <div>Date: 28-09-2021 Revision date: 15-10-2021 Revision nr.: D</div>
<div>Client: DEA Marine</div> <div><div>DANISH EXPORT ASSOCIATION MARINE</div></div> <div>Exhibition: Marintec 2021 Shanghai New International Expo Centre</div> <div></div>
<div>Comments:</div>
<div>The drawing is indicative and without responsibility. The drawing is NOT to scale. The stand-builder will have the final call in all decisions regarding stability and security. Some products are only shown to indicate locations, but not the actual product as this product may be changed. All design is subject to copyright by Standesign A/S</div>

GUIDANCE PICTURE
Colors, lights and materials can not be reproduced in reality, and can vary widely in relation to the image shown.





Standesign A/S
Alsvej 2F
5800 Nyborg
Denmark
Phone: +45 4484 6699

Project nr.:
Drawing nr.:
Drawing name:
Designed by:
Hall:
Booth:

DMG-MAR-21-12
3D-002
Bird View 2
TCH / SFT
-
-

Date:
Revision date:
Revision nr.:

28-09-2021
15-10-2021
D

Client: DEA Marine



DANISH
EXPORT
ASSOCIATION
MARINE

Exhibition: Marintec 2021
Shanghai New International Expo Centre



Comments:

The drawing is indicative and without responsibility. The drawing is NOT to scale.
The stand-builder will have the final call in all decisions regarding stability and security.
Some products are only shown to indicate locations, but not the actual product as this product may be changed.
All design is subject to copyright by
Standesign A/S

GUIDANCE PICTURE
Colors, lights and materials can not be reproduced in reality, and can vary widely in relation to the image shown.



<div><div><div>Standesign A/S Alsvej 2F 5800 Nyborg Denmark Phone: +45 4484 6699</div></div></div>	
Project nr.:	DMG-MAR-21-12
Drawing nr.:	3D-003
Drawing name:	Street View 1
Designed by:	TCH / SFT
Hall:	-
Booth:	-
Date:	28-09-2021
Revision date:	15-10-2021
Revision nr.:	D
Client: DEA Marine	
<div><div><div>DANISH EXPORT ASSOCIATION MARINE</div></div></div>	
Exhibition: Marintec 2021 Shanghai New International Expo Centre	
<div><div><div>marintec China</div></div></div>	
Comments:	
<div>The drawing is indicative and without responsibility. The drawing is NOT to scale. The stand-builder will have the final call in all decisions regarding stability and security. Some products are only shown to indicate locations, but not the actual product as this product may be changed. All design is subject to copyright by Standesign A/S</div>	

GUIDANCE PICTURE
Colors, lights and materials can not be reproduced in reality, and can vary widely in relation to the image shown.





Standesign A/S
Alsvej 2F
5800 Nyborg
Denmark
Phone: +45 4484 6699

Project nr.:
Drawing nr.:
Drawing name:
Designed by:
Hall:
Booth:

DMG-MAR-21-12
3D-004
Street View 2
TCH / SFT
-
-

Date:
Revision date:
Revision nr.:

28-09-2021
15-10-2021
D

Client: DEA Marine



Exhibition: Marintec 2021
Shanghai New International Expo Centre



Comments:

The drawing is indicative and without responsibility. The drawing is NOT to scale. The stand-builder will have the final call in all decisions regarding stability and security. Some products are only shown to indicate locations, but not the actual product as this product may be changed. All design is subject to copyright by Standesign A/S

GUIDANCE PICTURE
Colors, lights and materials can not be reproduced in reality, and can vary widely in relation to the image shown.





Standesign A/S
Alsvej 2F
5800 Nyborg
Denmark
Phone: +45 4484 6699

Project nr.:
Drawing nr.:
Drawing name:
Designed by:
Hall:
Booth:

DMG-MAR-21-12
3D-005
Street View 3
TCH / SFT
-
-

Date:
Revision date:
Revision nr.:

28-09-2021
15-10-2021
D

Client: DEA Marine



DANISH
EXPORT
ASSOCIATION
MARINE

Exhibition: Marintec 2021
Shanghai New International Expo Centre



Comments:

The drawing is indicative and without responsibility. The drawing is NOT to scale.
The stand-builder will have the final call in all decisions regarding stability and security.
Some products are only shown to indicate locations, but not the actual product as this product may be changed.
All design is subject to copyright by Standesign A/S

GUIDANCE PICTURE
Colors, lights and materials can not be reproduced in reality, and can vary widely in relation to the image shown.





Standesign A/S
Alsvej 2F
5800 Nyborg
Denmark
Phone: +45 4484 6699

Project nr.:
Drawing nr.:
Drawing name:
Designed by:
Hall:
Booth:

DMG-MAR-21-12
3D-006
Street View 4
TCH / SFT
-
-

Date:
Revision date:
Revision nr.:

28-09-2021
15-10-2021
D

Client: DEA Marine



DANISH
EXPORT
ASSOCIATION
MARINE

Exhibition: Marintec 2021
Shanghai New International Expo Centre



Comments:

The drawing is indicative and without responsibility. The drawing is NOT to scale.
The stand-builder will have the final call in all decisions regarding stability and security.
Some products are only shown to indicate locations, but not the actual product as this product may be changed.
All design is subject to copyright by
Standesign A/S

GUIDANCE PICTURE
Colors, lights and materials can not be reproduced in reality, and can vary widely in relation to the image shown.





Standesign A/S
Alsvej 2F
5800 Nyborg
Denmark
Phone: +45 4484 6699

Project nr.:
Drawing nr.:
Drawing name:
Designed by:
Hall:
Booth:

DMG-MAR-21-12
3D-007
Street View 5
TCH / SFT
-
-

Date:
Revision date:
Revision nr.:

28-09-2021
15-10-2021
D

Client: DEA Marine



DANISH
EXPORT
ASSOCIATION
MARINE

Exhibition: Marintec 2021
Shanghai New International Expo Centre



Comments:

The drawing is indicative and without responsibility. The drawing is NOT to scale.
The stand-builder will have the final call in all decisions regarding stability and security.
Some products are only shown to indicate locations, but not the actual product as this product may be changed.
All design is subject to copyright by Standesign A/S

GUIDANCE PICTURE
Colors, lights and materials can not be reproduced in reality, and can vary widely in relation to the image shown.

Project nr.: DMG-MAR-21-12
Drawing nr.: FP-001
Drawing name: Floor Plan
Designed by: TCH / SFT
Hall: -
Booth: -

Date: 28-09-2021
Revision date: 15-10-2021
Revision nr.: D

Client: DEA Marine



Exhibition: Marintec 2021
Shanghai New International Expo Centre

Comments:

The drawing is indicative and without responsibility. The drawing is NOT to scale.
The stand-builder will have the final call in all decisions regarding stability and security.
Some products are only shown to indicate locations, but not the actual product as this product may be changed.
All design is subject to copyright by Standesign A/S

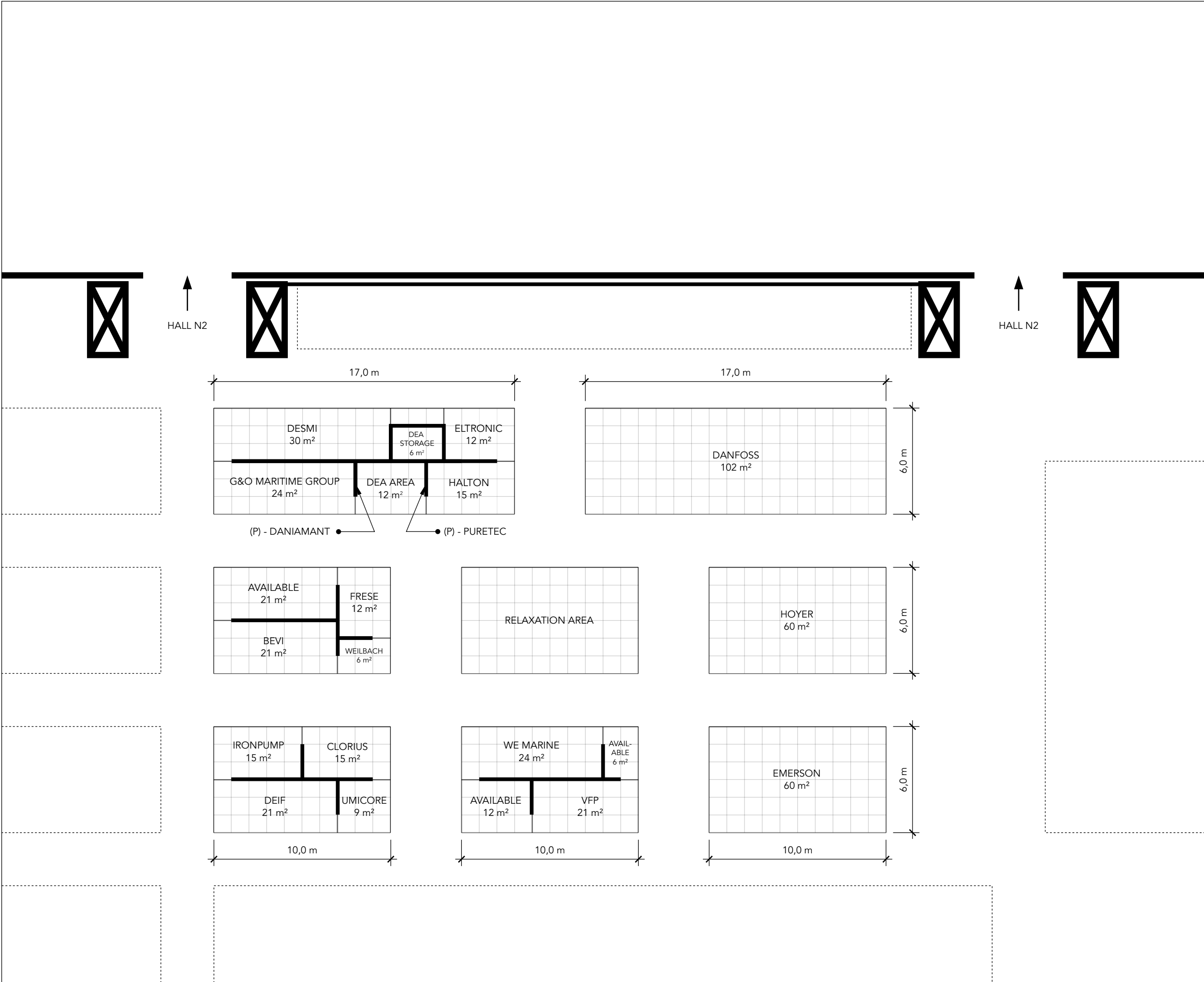

ELEVATION FRONT

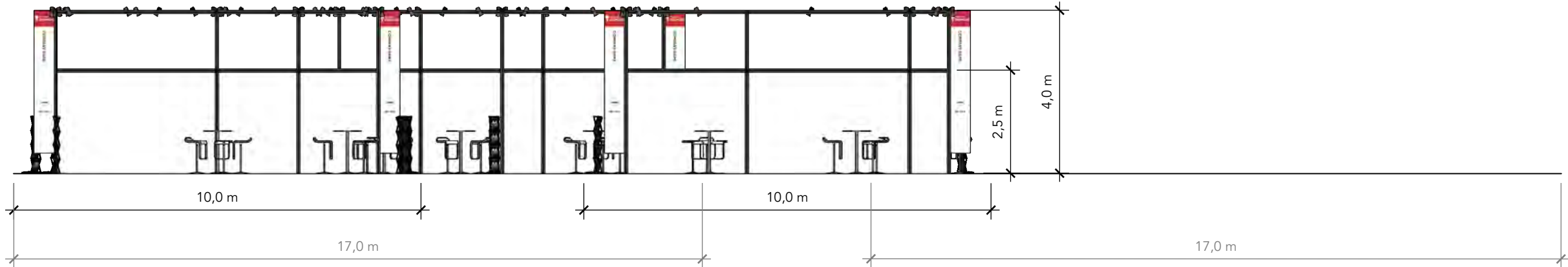

Project nr.: DMG-MAR-21-12
Drawing nr.: FP-001
Drawing name: Floor Plan
Designed by: TCH / SFT
Hall: -
Booth: -

Date: 28-09-2021
Revision date: 15-10-2021
Revision nr.: D

Client: DEA Marine



Exhibition: Marintec 2021
Shanghai New International Expo Centre

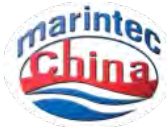

Comments:

ELEVATION SIDE

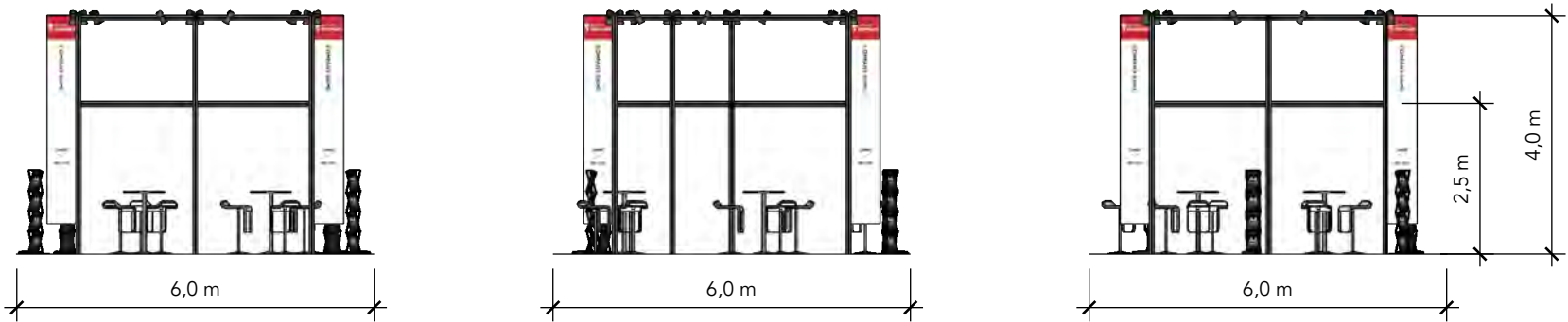

The drawing is indicative and without responsibility. The drawing is NOT to scale.
The stand-builder will have the final call in all decisions regarding stability and security.
Some products are only shown to indicate locations, but not the actual product as this product may be changed.
All design is subject to copyright by Standesign A/S