



FURNITURE CATALOGUE

Nor-Shipping - 10th – 13th of January 2022



/ RÅDGIVNING / DESIGN / HÅNDVÆRK / TEKNOLOGI

STANDESIGN A/S - ALSVEJ 2F - 5800 NYBORG - DENMARK - T: +45 44846699 - E: INFO@STANDESIGN.DK

COUNTER - FLAT

Info disk

Description

Laminate top, with painted sides and front.
2 lockable cabinets at 60 cm and 40 cm width.

There is room for a fridge or freezer in the 60 cm cabinet.

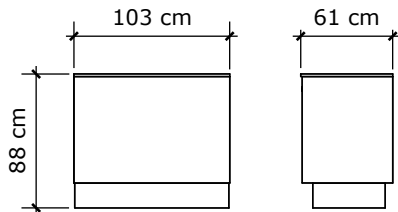

Graphics Dimensions:

Front: W 1030 mm x H 704 mm

Sides: W 599 mm x H 704 mm

- Print ready PDF file
(or logo in vector format (EPS or AI))
- Add 10 mm bleed
- All text must be outlined
- All images must be 100 dpi
- All colors will be printed in CMYK

Order list:

- Info Counter - Flat

COUNTER - SERVING

Info disk med serveringstop

Description

Laminate top and serving top, with painted sides and front.
2 lockable cabinets at 60 cm and 40 cm width.

There is room for a fridge or freezer in the 60 cm cabinet.

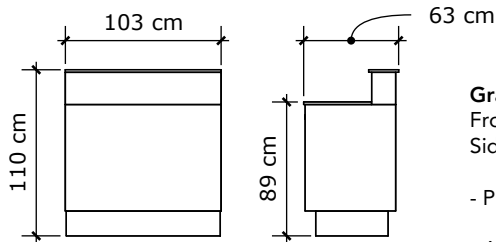

Graphics Dimensions:

Front: W 1030 mm x H 917 mm

Sides: W 599 mm x H 704 mm

- Print ready PDF file
(or logo in vector format (EPS or AI))
- Add 10 mm bleed
- All text must be outlined
- All images must be 100 dpi
- All colors will be printed in CMYK



Order list:

- Info Counter - Serving Top

Color options:



White

Other colors are possible for an additional cost

COUNTER - OCTA

Info disk - Octanorm

Description

Info counter made in our standard framing system. Front and sides can be fitted with printed surfaces. Internal storage on shelves, with sliding doors. The doors are NOT lockable.

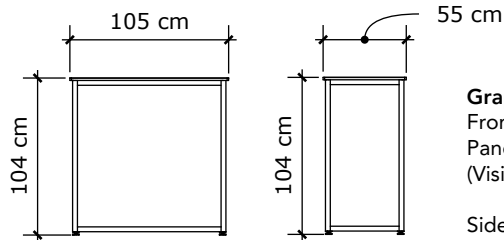
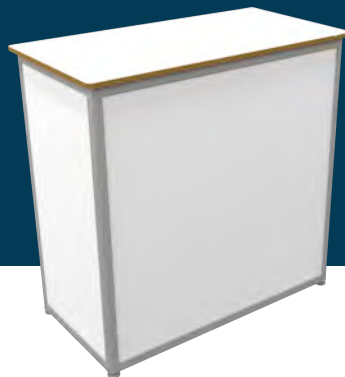

Graphics Dimensions:

Front:

Panel size: W 964 mm x H 950 mm
(Visible area: W 950 mm x H 936 mm)

Sides:

Panel size: W 469 mm x H 950 mm
(Visible area: W 455 mm x H 936 mm)

- Print ready PDF file
(or logo in vector format (EPS or AI))
- Add 10 mm bleed
- All text must be outlined
- All images must be 100 dpi
- All colors will be printed in CMYK



Order list:

- Info Counter - System

Color options:



White

Other colors are possible for an additional cost

TABLE - STANDARD 1

Bord - Standard 1

Description

Table top is laminated. Stem and base is powdercoated.

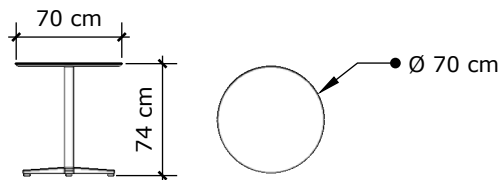

Order list:
- Table Low

Colours of stem and base:

 White

 Silver

Other colours for table top are possible
for an additional cost

BAR TABLE - STANDARD 1

Barbord - Standard 1

Description

Table top is laminated. Stem and base is powdercoated.

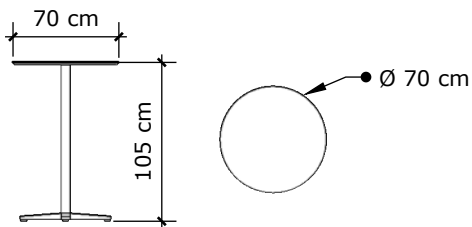

Order list:
- Table High

Colours of stem and base:



White



Silver

Other colours for table top are possible
for an additional cost

CHAIR - STANDARD 1

Stol - Standard 1

Description

The seat is laminated wood. The legs are brushed steel.
The chair is stackable.

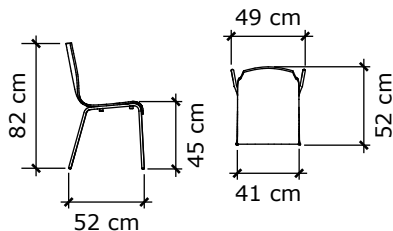

Order list:

- Chair

Colours of legs and seat:



White



Silver

Other colours for seat are possible for
an additional cost

BAR CHAIR - STANDARD 1

Bar stol - Standard 1

Description

The seat is laminated wood. The legs are brushed steel.
The chair is stackable.

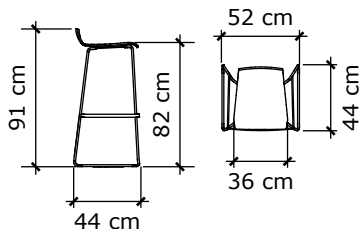
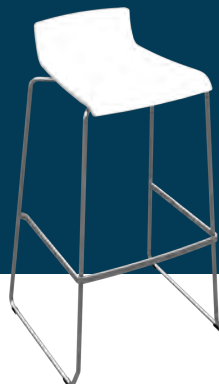

Order list:

- Bar Stool

Colours of legs and seat:



White



Silver

Other colours for seat are possible for
an additional cost

TV STAND

Fod til TV

Description

TV stand for TV screens up to 40".
The base is galvanized cast iron.
The stand is aluminum matte finish.

Maximum height for top of TV screen = 2 m

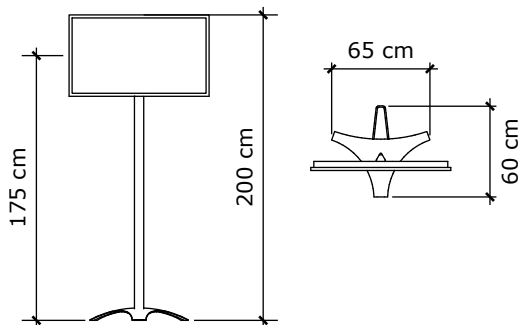
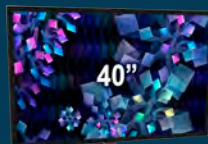

Order list:
- TV Stand

TV PODIUM

TV podie

Description

Tv podium with a painted matte finish.
Lockable front door.

TV not included. TV above 40" is not recommended.

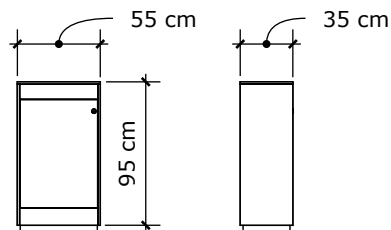

Order list:

- TV Podium - White
- TV Podium - Black

Color options:



White



Black

Other colors are possible for an additional cost

BROCHURE STAND - SWING-UP

Brochureholder - Swing-Up

Description

Powder-coated black brochure stand in steel.
There are 5 shelves with room for A4 brochures.

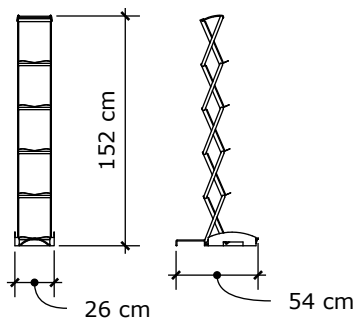

Order list:
- Brochure Stand Black