



FURNITURE CATALOGUE

CFIA, RENNES, FRANCE

14th - 16th MARCH 2023

 STANDESIGN

 RÅDGIVNING  DESIGN  HÅNDVÆRK  TEKNOLOGI

STANDESIGN A/S - ALSVEJ 2F - 5800 NYBORG - DENMARK - T: +45 44846699 - E: INFO@STANDESIGN.DK

TABLE - STANDARD

Bord - Standard

Description

Table in suitable height for standard chairs.
Table top is laminated.
Stem and base are powder coated.

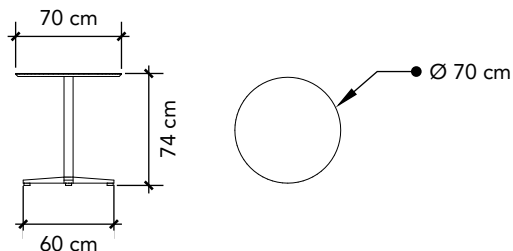

Order Form Title:

- Table, standard - Metallic Gray base
- Table, standard - White base

Colour options for stem + base:

-  White
-  Metallic Gray

Colour options for table top:

-  White

Other colours for table top are possible
for an additional cost

TABLE - BAR

Bord - Barbord

Description

Table in suitable height for bar chairs or standing.
Table top is laminated.
Stem and base are powder coated.

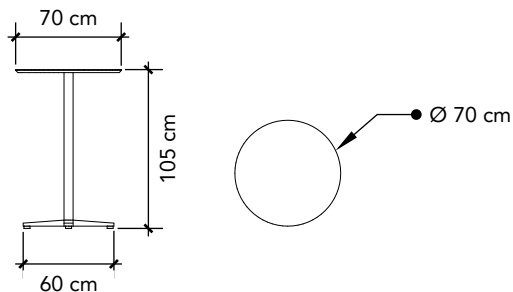

Order Form Title:

- Table, bar - Metallic Gray base
- Table, bar - White base

Colour options for stem + base:

-  White
-  Metallic Gray

Colour options for table top:

-  White

Other colours for table top are possible
for an additional cost

CHAIR - STANDARD

Stol - Standard

Description

Chair with seat height suitable for standard table.
The seat is laminated wood.
Frame is in brushed steel.
The chair is stackable.

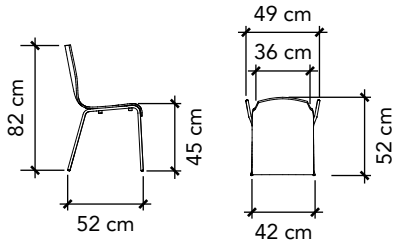

Order Form Title:
- Chair, standard

Colour of frame:



Metallic Gray

Colour of seat:



White

Other colours for seat are possible for
an additional cost

CHAIR - BAR

Stol - Barstol

Description

Bar chair with seat height suitable for bar table.
The seat is laminated wood.
Frame is in brushed steel.
The chair is stackable.

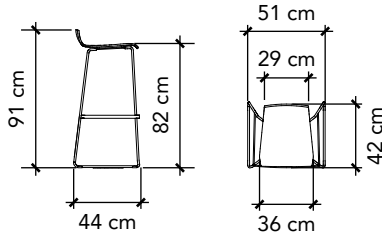
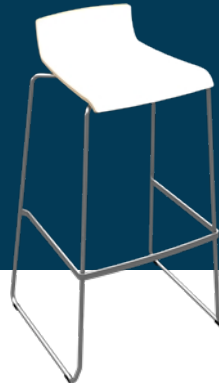

Order Form Title:
- Chair, bar

Colour of frame:



Colour of seat:



Other colours for seat are possible for
an additional cost

COUNTER - STANDARD

Info disk - Standard

Description

Table top is laminate.
Sides and front are painted.
2 lockable cabinets at 60 cm and 40 cm width.

There is room for a small fridge or freezer
in the 60 cm cabinet.

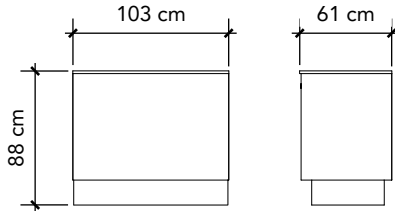

Graphics Dimensions:

Front: W 1030 mm x H 704 mm

Sides: W 599 mm x H 704 mm

Print INFO:

- Print ready PDF file
(or logo in vector format (EPS or AI))
- Add 10 mm bleed
- All text must be outlined
- All images must be 100 dpi
- All colors will be printed in CMYK

Order Form Title:

- Info Counter, standard

Colour options:



Other colours are possible for an
additional cost

COUNTER - BAR TOP

Info disk med serveringstop

Description

Table top and bar top are both laminate.
Sides and front are painted.
2 lockable cabinets at 60 cm and 40 cm width.

There is room for a small fridge or freezer
in the 60 cm cabinet.

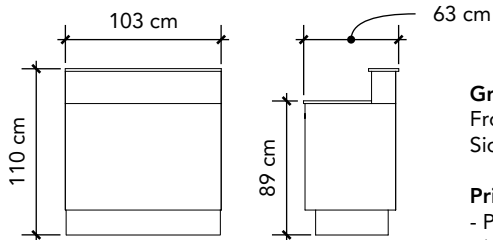

Graphics Dimensions:

Front: W 1030 mm x H 917 mm

Sides: W 599 mm x H 704 mm

Print INFO:

- Print ready PDF file
(or logo in vector format (EPS or AI))
- Add 10 mm bleed
- All text must be outlined
- All images must be 100 dpi
- All colors will be printed in CMYK

Order Form Title:

- Info Counter, w/ bar top

Colour options:



Other colours are possible for an
additional cost

COUNTER - OCTANORM

Info disk - Octanorm

Description

Info counter made in our standard framing system. Front and sides can be fitted with printed surfaces. Internal storage on shelves. Sliding doors on back side. These doors are NOT lockable.

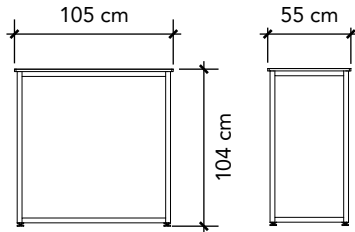
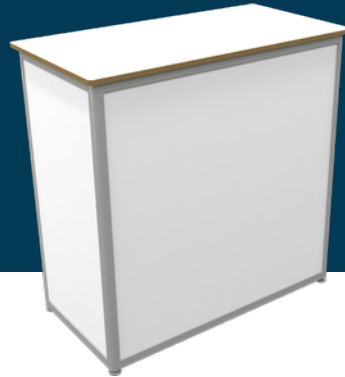

Graphics Dimensions:

Front:

Panel size: W 964 mm x H 950 mm
(Visible area: W 950 mm x H 936 mm)

Sides:

Panel size: W 469 mm x H 950 mm
(Visible area: W 455 mm x H 936 mm)

Print INFO:

- Print ready PDF file
(or logo in vector format (EPS or AI))
- Add 10 mm bleed
- All text must be outlined
- All images must be 100 dpi
- All colors will be printed in CMYK

Order Form Title:

- Info Counter, OCTANORM system

Colour of frame:



Metallic Gray

Colour of panels:



White

Other colours for panels are possible for an additional cost

MONITORS - LCD

Skærme - LCD

Description

LCD Monitor of different brands and in several sizes.
Used for videos, slideshows or other media.

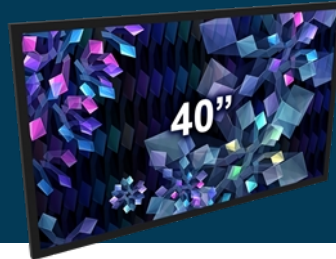

Size info (with bezel*):

- 32" = W 708 x H 398 mm (768 x 458 mm)
- 40" = W 886 x H 498 mm (946 x 558 mm)
- 42" = W 930 x H 523 mm (990 x 583 mm)
- 43" = W 952 x H 535 mm (1012 x 595 mm)
- 55" = W 1218 x H 685 mm (1278 x 745 mm)
- 75" = W 1660 x H 934 mm (1720 x 994 mm)

*Bezels varies from model to model.
These are just approximate values.

Image above is just an example
of a 40" monitor.

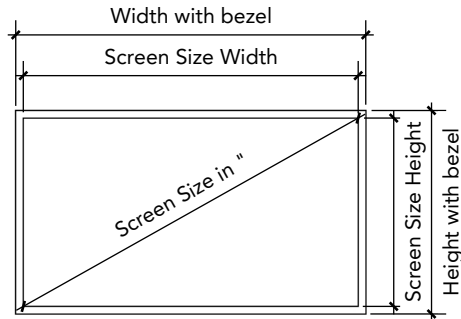

Order Form Title:

- Monitor, LCD - 32"
- Monitor, LCD - 40"
- Monitor, LCD - 42"
- Monitor, LCD - 43"
- Monitor, LCD - 55"
- Monitor, LCD - 75"

Other sizes are possible

MONITOR FLOOR STAND

Fod til skærm

Description

Monitor floor stand for monitors up to 40".
The base is galvanized cast iron.
The stem is aluminum matte finish.

Monitor not included.

Maximum height for top of monitor = 2 m

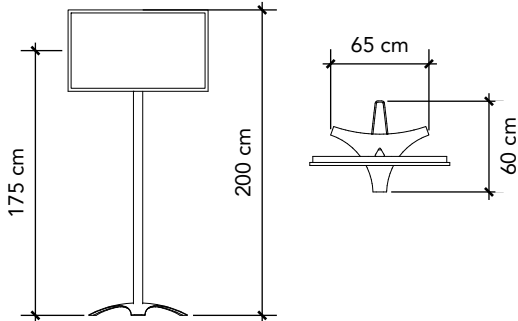

Order Form Title:

- Monitor Floor Stand

Colour of stem + base:



PODIUM - FOR MONITOR

Podie til skærm

Description

Podium/cabinet with a painted matte finish.
Used for monitors or product display.
Lockable front door.

Monitor not included.

Monitor above 40" is not recommended.

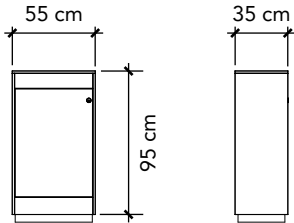

Order Form Title:

- Podium, for monitor - White
- Podium, for monitor - Black

Colour options:

- White
- Black

Other colours are possible for an additional cost

PODIUMS - STANDARD

Podie - Standard

Description

Podium in a painted matte finish (roller painted).
Used for product display.
Available in two different heights.

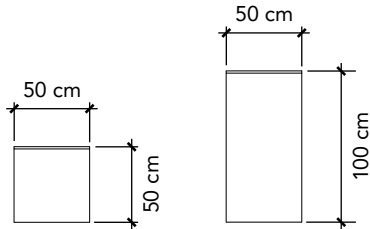
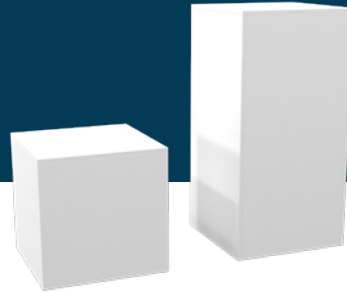

Order Form Title:

- Podium, standard, low - White
- Podium, standard, high - White
- Podium, standard, low - Black
- Podium, standard, high - Black

Colour options:



White



Black

Other sizes and colours are possible for
an additional cost

BROCHURE DISPLAY - SWING-UP

Brochureholder - Swing-Up

Description

Brochure stand in black powder-coated steel.
There are 5 shelves with room for A4 brochures.

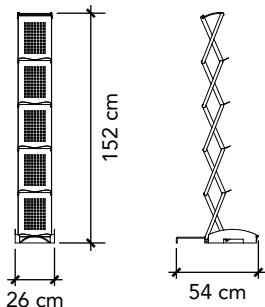

Order Form Title:
- Brochure Stand, Swing-Up

Colour options:



Black