



## FURNITURE CATALOGUE

**TARGI WOD-KAN,**  
**Bydgoszcz, 30<sup>th</sup> May -**  
**1<sup>st</sup> June 2023**



/ RÅDGIVNING / DESIGN / HÅNDVÆRK / TEKNOLOGI

# TABLE - STANDARD

Bord - Standard

## Description

Table in suitable height for standard chairs.  
Table top is laminated.  
Stem and base are powder coated.

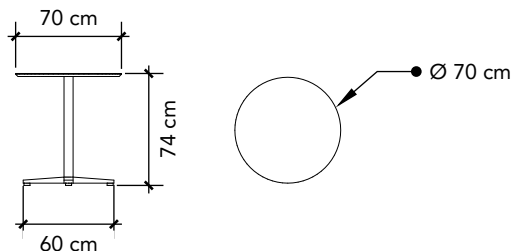

## Order Form Title:

- Table, standard - Metallic Gray base
- Table, standard - White base

## Colour options for stem + base:



White



Metallic Gray

## Colour options for table top:



White

Other colours for table top are possible  
for an additional cost

# TABLE - BAR

Bord - Barbord

## Description

Table in suitable height for bar chairs or standing.  
Table top is laminated.  
Stem and base are powder coated.

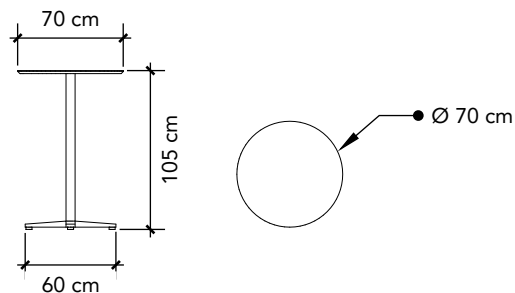

## Order Form Title:

- Table, bar - Metallic Gray base
- Table, bar - White base

## Colour options for stem + base:



White



Metallic Gray

## Colour options for table top:



White

Other colours for table top are possible  
for an additional cost

# CHAIR - STANDARD

Stol - Standard

## Description

Chair with seat height suitable for standard table.  
The seat is laminated wood.  
Frame is in brushed steel.  
The chair is stackable.

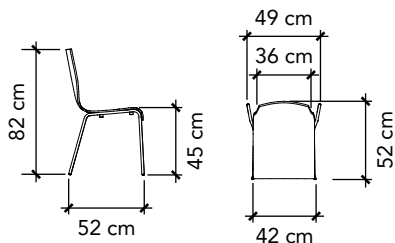

## Order Form Title:

- Chair, standard

## Colour of frame:



Metallic Gray

## Colour of seat:



White

Other colours for seat are possible for an additional cost

# CHAIR - BAR

Stol - Barstol

## Description

Bar chair with seat height suitable for bar table.  
The seat is laminated wood.  
Frame is in brushed steel.  
The chair is stackable.

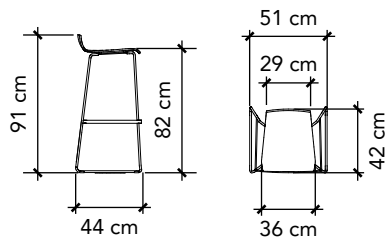

**Order Form Title:**  
- Chair, bar

**Colour of frame:**



Metallic Gray

**Colour of seat:**



White

Other colours for seat are possible for  
an additional cost

# COUNTER - STANDARD

Info disk - Standard

## Description

Table top is laminate.  
Sides and front are painted.  
2 lockable cabinets at 60 cm and 40 cm width.

There is room for a small fridge or freezer  
in the 60 cm cabinet.

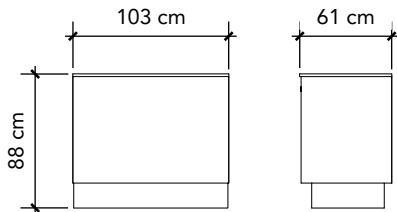

## Graphics Dimensions:

Front: W 1030 mm x H 704 mm

Sides: W 599 mm x H 704 mm

## Print INFO:

- Print ready PDF file  
(or logo in vector format (EPS or AI))
- Add 10 mm bleed
- All text must be outlined
- All images must be 100 dpi
- All colors will be printed in CMYK

## Order Form Title:

- Info Counter, standard

## Colour options:



White

Other colours are possible for an  
additional cost

# COUNTER - BAR TOP

Info disk med serveringstop

## Description

Table top and bar top are both laminate.  
Sides and front are painted.  
2 lockable cabinets at 60 cm and 40 cm width.

There is room for a small fridge or freezer  
in the 60 cm cabinet.

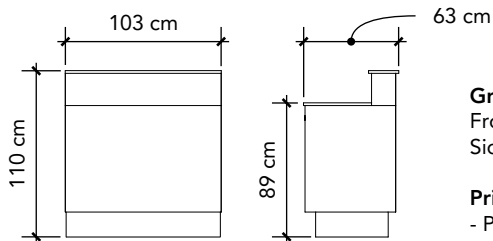

## Graphics Dimensions:

Front: W 1030 mm x H 917 mm

Sides: W 599 mm x H 704 mm

## Print INFO:

- Print ready PDF file  
(or logo in vector format (EPS or AI))
- Add 10 mm bleed
- All text must be outlined
- All images must be 100 dpi
- All colors will be printed in CMYK

## Order Form Title:

- Info Counter, w/ bar top

## Colour options:



White

Other colours are possible for an  
additional cost

# COUNTER - OCTANORM

Info disk - Octanorm

## Description

Info counter made in our standard framing system.  
Front and sides can be fitted with printed surfaces.  
Internal storage on shelves.  
Sliding doors on back side.  
These doors are NOT lockable.

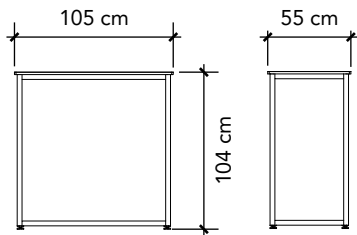
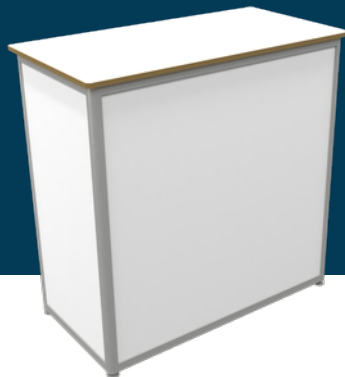

## Graphics Dimensions:

Front:

Panel size: W 964 mm x H 950 mm  
(Visible area: W 950 mm x H 936 mm)

Sides:

Panel size: W 469 mm x H 950 mm  
(Visible area: W 455 mm x H 936 mm)

## Print INFO:

- Print ready PDF file  
(or logo in vector format (EPS or AI))
- Add 10 mm bleed
- All text must be outlined
- All images must be 100 dpi
- All colors will be printed in CMYK

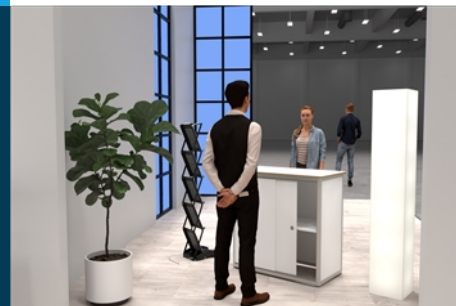

## Order Form Title:

- Info Counter, OCTANORM system

## Colour of frame:



Metallic Gray

## Colour of panels:



White

Other colours for panels are possible  
for an additional cost



# MONITORS - LCD

Skærme - LCD

## Description

LCD Monitor of different brands and in several sizes.  
Used for videos, slideshows or other media.

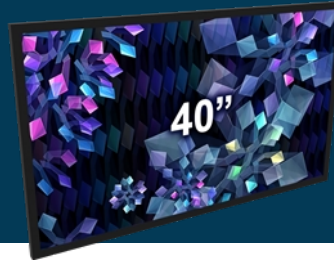

Size info (with bezel\*):

- 32" = W 708 x H 398 mm (768 x 458 mm)
- 40" = W 886 x H 498 mm (946 x 558 mm)
- 42" = W 930 x H 523 mm (990 x 583 mm)
- 43" = W 952 x H 535 mm (1012 x 595 mm)
- 55" = W 1218 x H 685 mm (1278 x 745 mm)
- 75" = W 1660 x H 934 mm (1720 x 994 mm)

\*Bezels varies from model to model.  
These are just approximate values.

Image above is just an example  
of a 40" monitor.

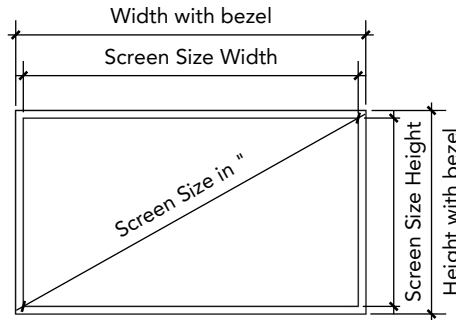

## Order Form Title:

- Monitor, LCD - 32"
- Monitor, LCD - 40"
- Monitor, LCD - 42"
- Monitor, LCD - 43"
- Monitor, LCD - 55"
- Monitor, LCD - 75"

Other sizes are possible

# MONITOR FLOOR STAND

Fod til skærm

## Description

Monitor floor stand for monitors up to 40".  
The base is galvanized cast iron.  
The stem is aluminum matte finish.

Monitor not included.

Maximum height for top of monitor = 2 m

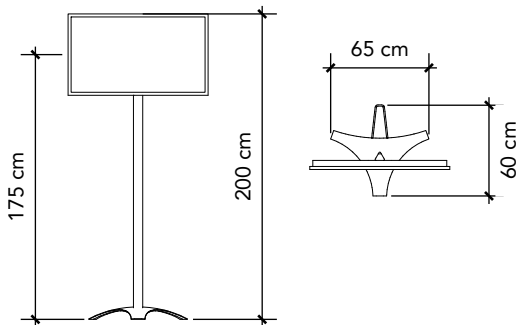

## Order Form Title:

- Monitor Floor Stand

## Colour of stem + base:



Metallic Gray

# PODIUM - FOR MONITOR

Podie til skærm

## Description

Podium/cabinet with a painted matte finish.  
Used for monitors or product display.  
Lockable front door.

Monitor not included.

Monitor above 40" is not recommended.

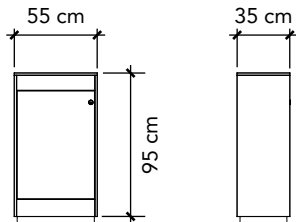

## Order Form Title:

- Podium, for monitor - White
- Podium, for monitor - Black

## Colour options:



White



Black

Other colours are possible for an additional cost

# PODIUMS - STANDARD

Podie - Standard

## Description

Podium in a painted matte finish (roller painted).  
Used for product display.  
Available in two different heights.

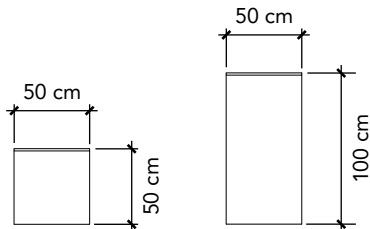
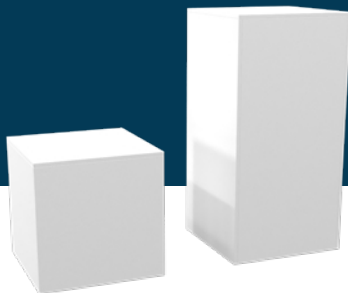

## Order Form Title:

- Podium, standard, low - White
- Podium, standard, high - White
- Podium, standard, low - Black
- Podium, standard, high - Black

## Colour options:



White



Black

Other sizes and colours are possible for  
an additional cost

# BROCHURE DISPLAY - SWING-UP

Brochureholder - Swing-Up

## Description

Brochure stand in black powder-coated steel.  
There are 5 shelves with room for A4 brochures.

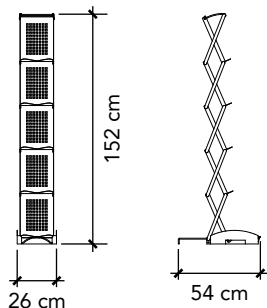

**Order Form Title:**  
- Brochure Stand, Swing-Up

**Colour options:**



Black