

IFAT 2026

Danish Export Association

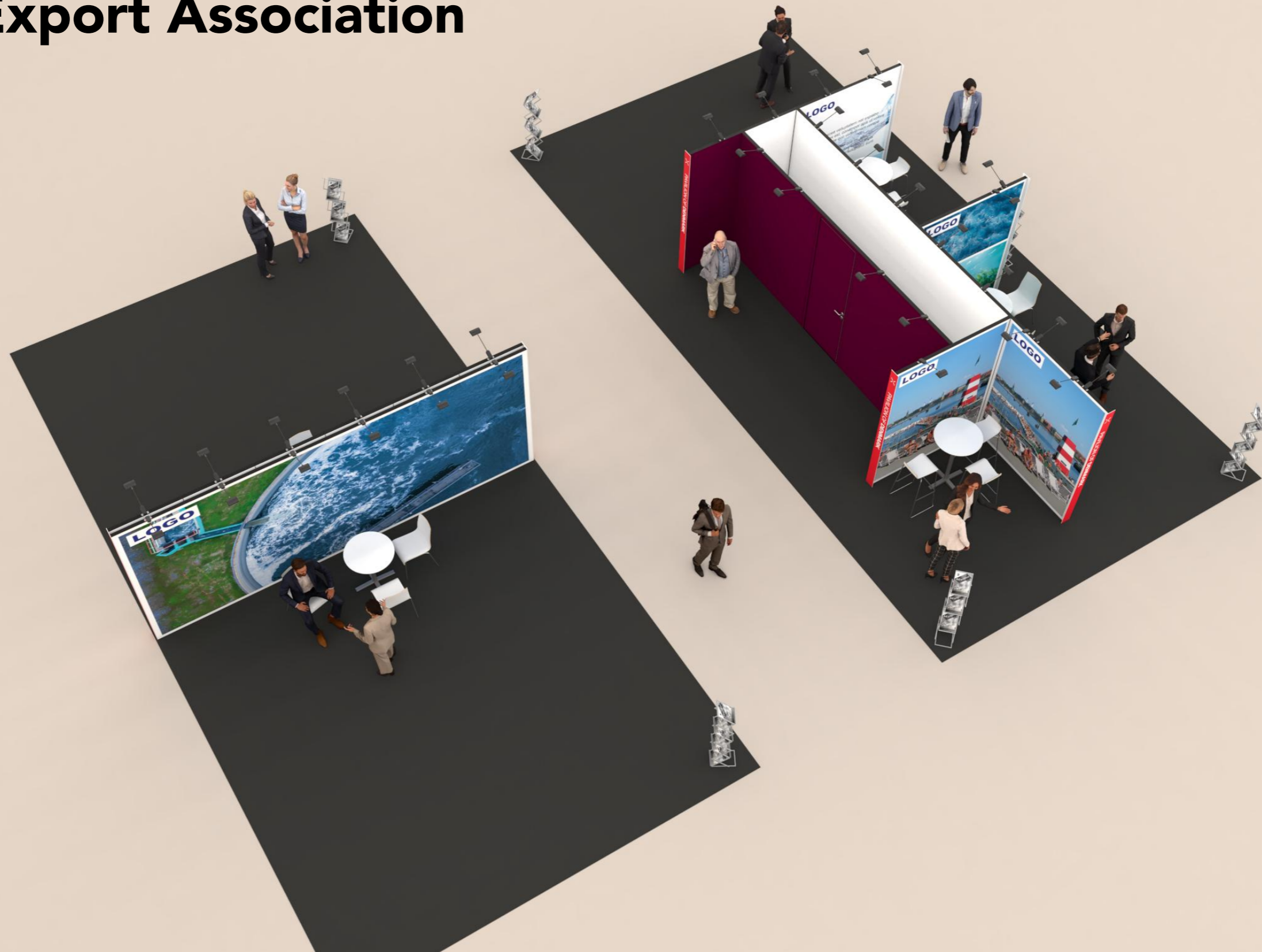

Table of Contents

Cover	1
Table of Contents	2
3D View 1	3
3D View 2	4
3D View 3	5
3D View 4	6
Floor Plan	7
Graphics Dimensions	8
Elevations	9
Info	10

3D View 1



3D View 2

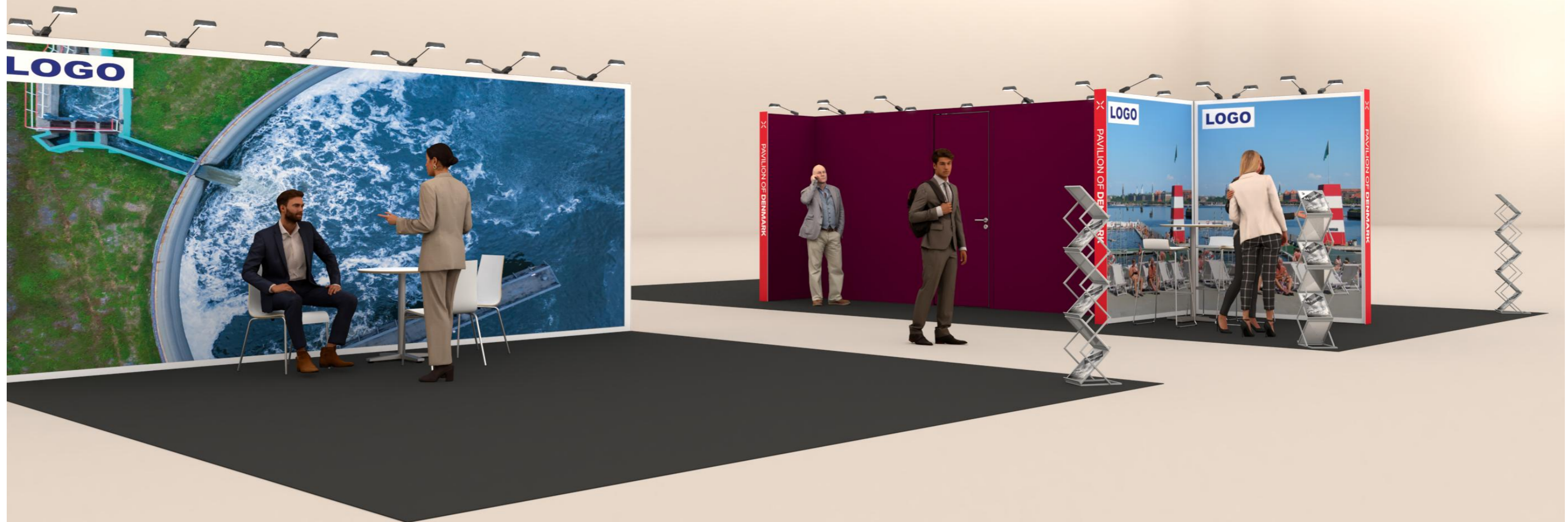

3D View 3

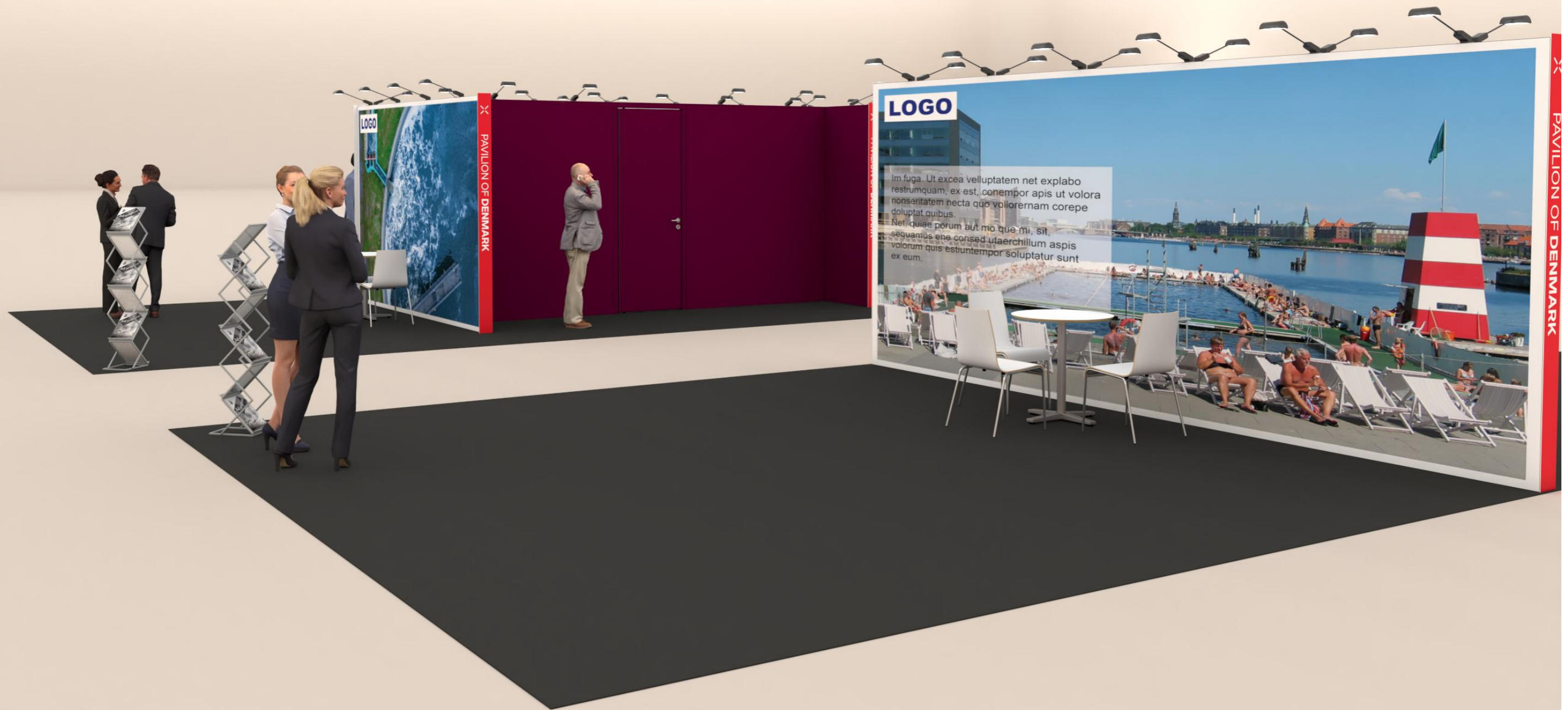

3D View 4



Floor Plan

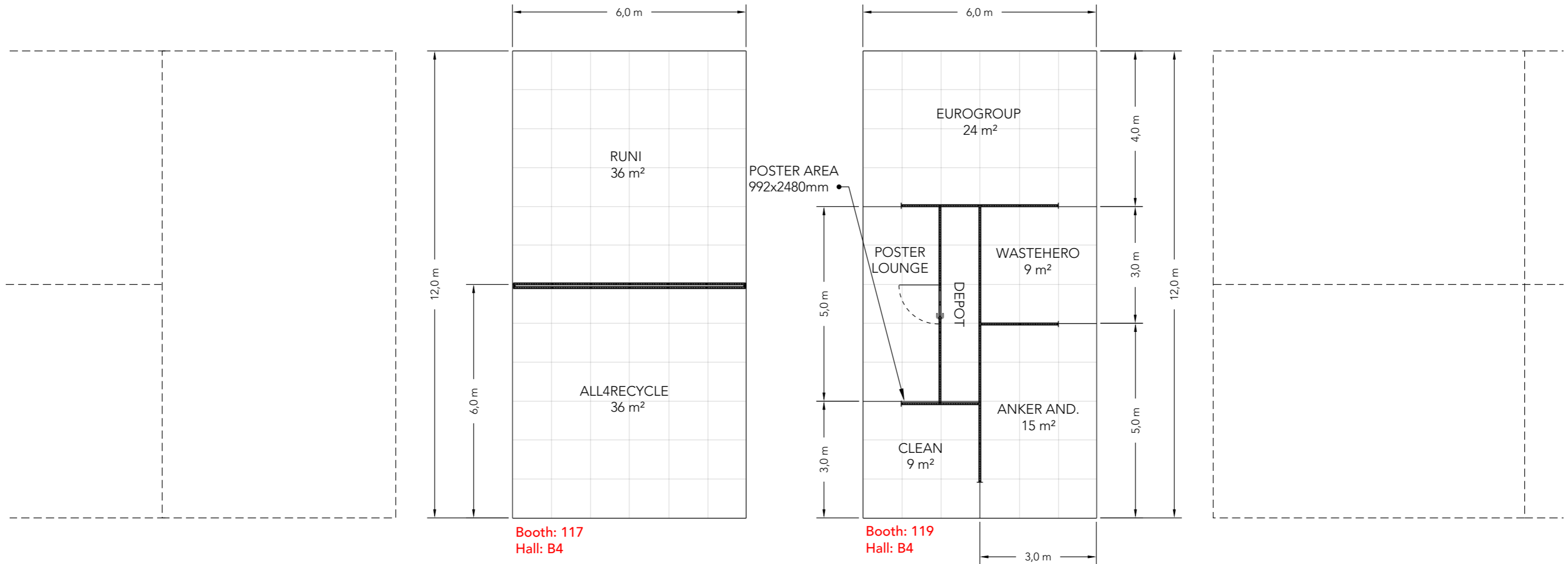

Graphics Dimensions

WALL HEIGHT: 2480mm

DOOR HEIGHT: 2398mm

- Full size Fabric
- Single Frame Fabric

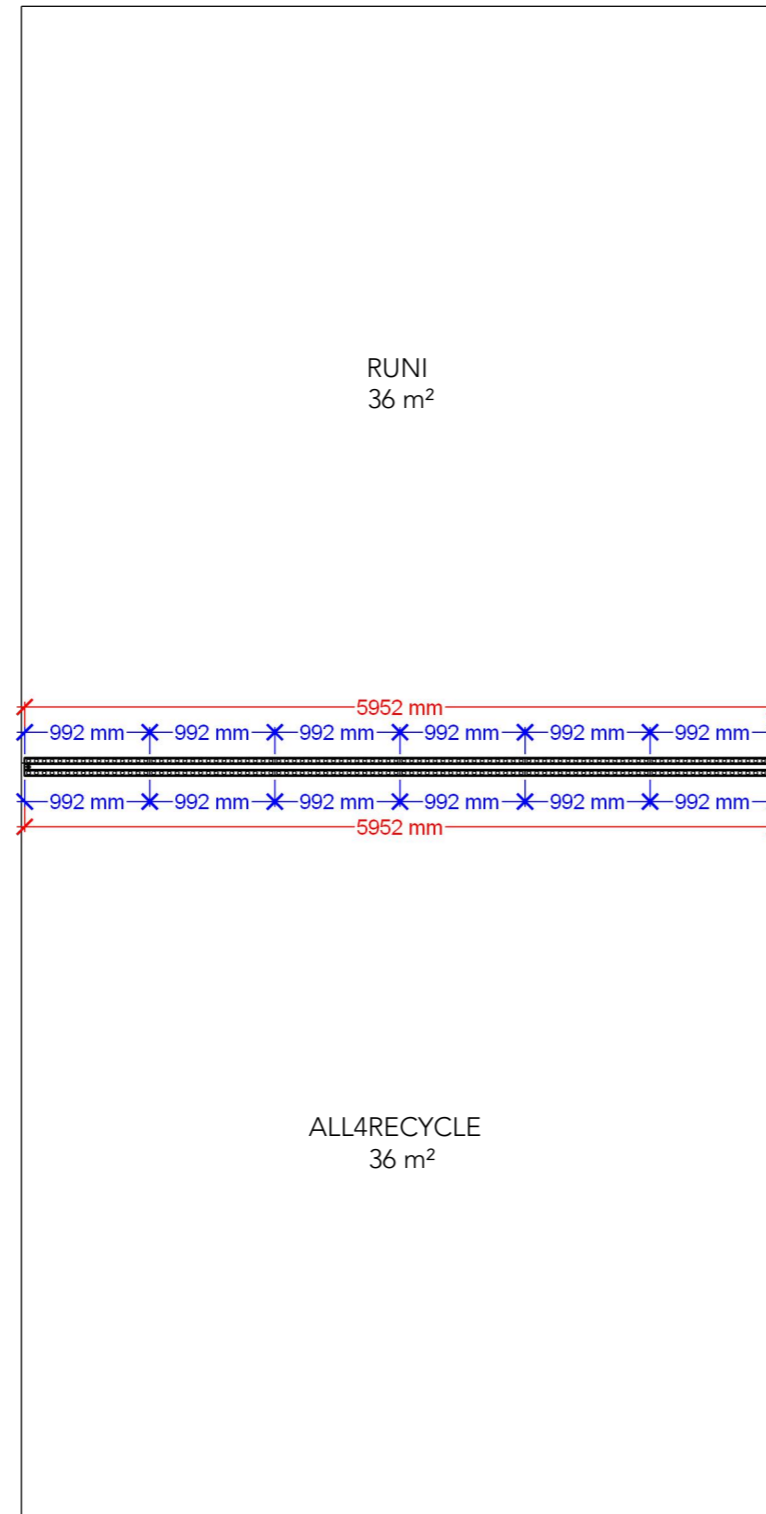

POSTER AREA
992x2480mm

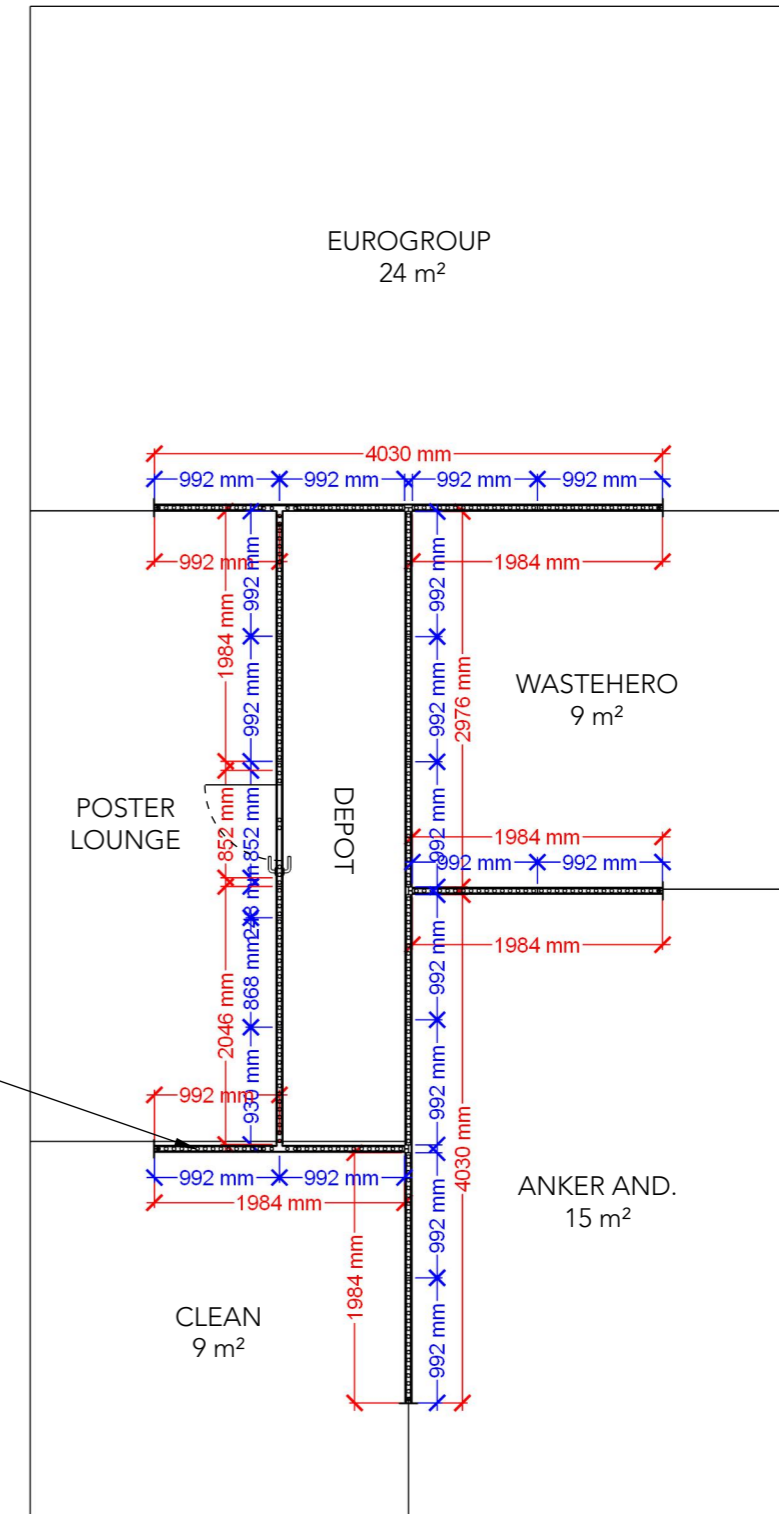

Elevations

Front

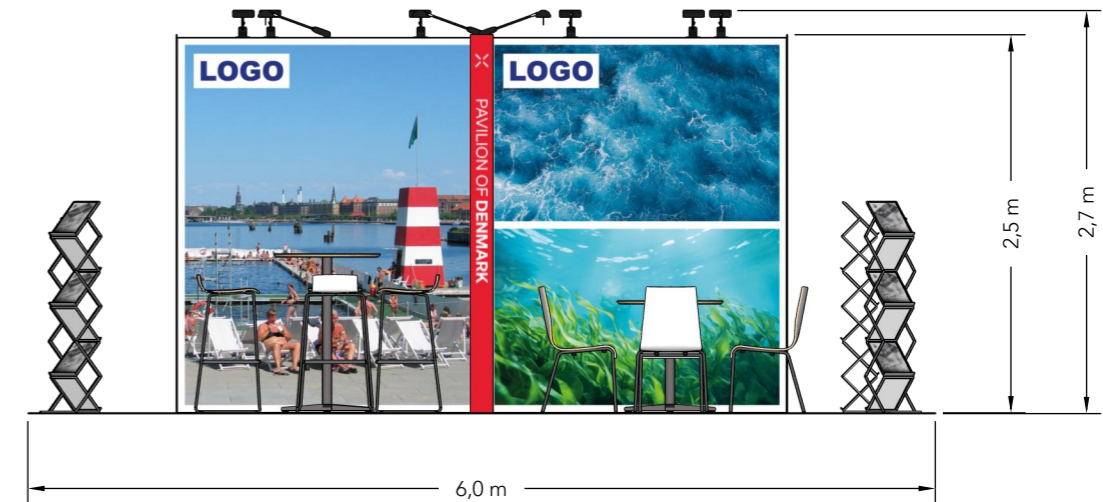
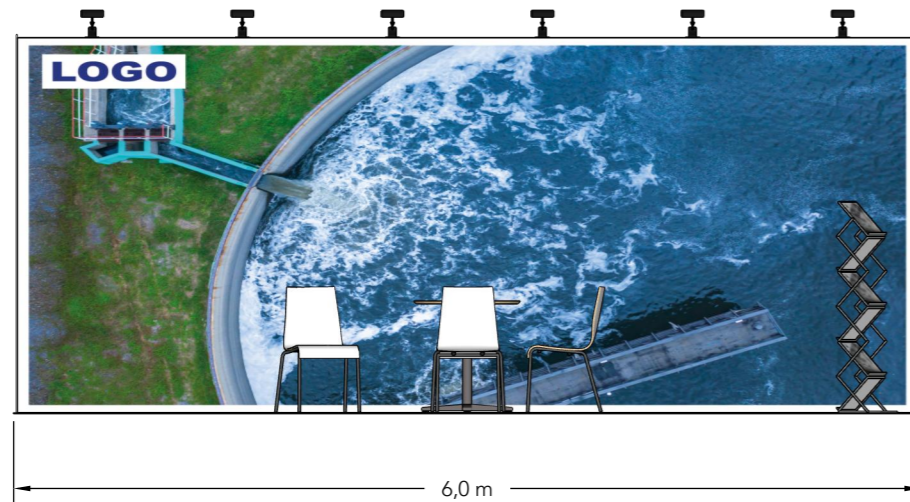

Side

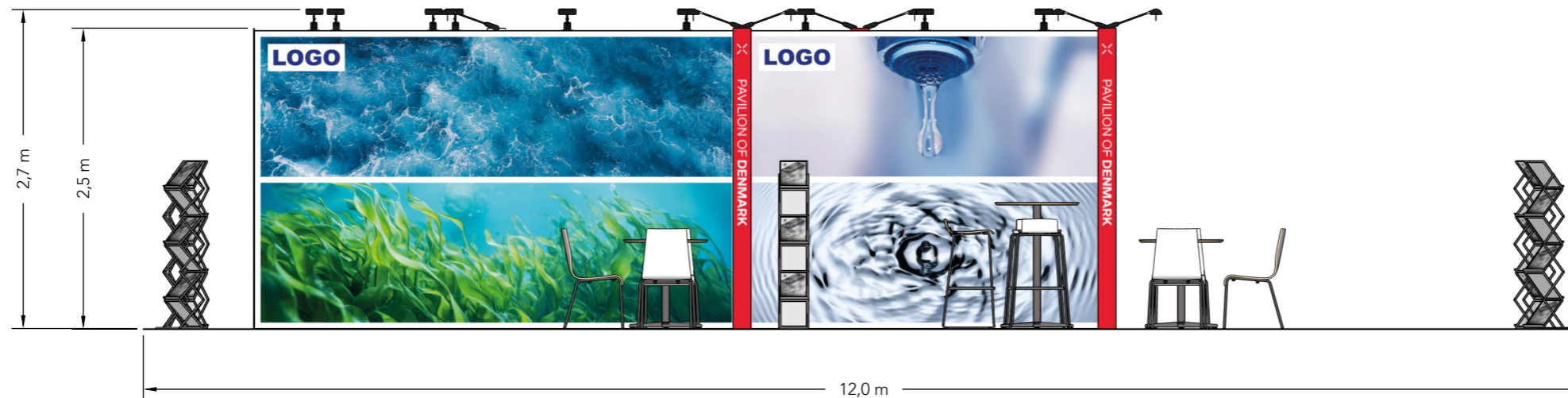

Info

Client: Danish Export Association
Exhibition: IFAT 2026

Project no.: (DEE-IFA-26-05)
Designed By: SMH
Hall: B4
Booth: Multiple

Creation Date: 12.02.2026
Revision Date: 25.02.2026
Revision no.: 01

Comments:

The drawing is indicative and without responsibility. The drawing is NOT to scale. The stand-builder will have the final call in all decisions regarding stability and security. Some products are only shown to indicate locations, but not the actual product as this product may be changed.
All design is subject to copyright by Compass Fairs A/S and Standesign A/S

