

# Find your graphic dimensions

## **Page 3**

BLUE WATER SHIPPING  
C.C. JENSEN  
CLOBOTICS WIND SERVICES  
DHI  
DOKKA FASTNERS  
DTU WIND & ENERGY SYSTEMS  
ENGISO ENGINEERED SOLUTIONS  
FOLKELARSEN  
FOLSGAARD  
FT TECHNOLOGIES  
GRANLY GROUP  
ISC CONSULTING ENGINEERS  
LIFTRA  
N.C. NIELSEN  
NEW POWER PARTNERS  
SABIK OFFSHORE  
SCANEL INTERNATIONAL  
SCANRECO  
SPICA TECHNOLOGY  
UNITED WIND FORCE  
DEE STORAGE / KITCHEN

## **Page 4**

CCB SAFETY  
DANSK GUMMI INDUSTRI  
DANSK POLYGLAS  
DESITEK  
HAWE ENERGY SOLUTIONS  
ICM SAFETY  
SCANDILOC  
SEMCO MARITIME  
ØGLÆND SYSTEMS

## **Page 5**

BAETTER SALES & SERVICE  
DYNAMICA ROPES  
ECM INDUSTRIES  
GRENE WIS  
ITW DENSIT  
KLINGSPOR  
LJM LIND JENSEN  
P. LINDBERG  
RESOLUX  
TEKNOLOGISK INSTITUT  
DEE BARISTA

## **Page 6**

AALBORG GUMMIVAREFABRIK  
ALUWIND  
B6 NORDIC  
COTES  
CS WIND OFFSHORE  
DANISH WIND POWER ACADEMY  
ENABL  
HEMPEL  
HYDRASPECMA  
LARKO MAGNET WIND  
MEGATRADE  
NORDIC WIND TECHNOLOGY  
POWERCURVE  
READ UNIT  
ROSE HOLM  
SDK SHIPPING  
TRCA  
ZIEHL-ABEGG  
DEE STORAGE

## **Page 7**

BILA  
DAFA  
EVAPCO  
HEAD ENERGY DENMARK  
ODENSE PORT  
SEASIGHT DAVITS  
SH GROUP  
SP GROUP  
STILLSTROM  
TERMA  
VIKING LIFE-SAVING EQUIPMENT  
ØSTERMARK GROUTING

## **Page 8**

CONNECTED WIND SERVICES  
DEIF  
DUELCO  
FORCE TECHNOLOGY  
HYTOR  
NIBE ELEMENT SOLUTIONS  
SCANCON ENCODERS  
AVAILABLE

## **Page 9**

COWI  
SOLID SAFETY  
AVAILABLE  
EXHIBITOR LOUNGE

## **Page 10**

ANTIRE  
PP TECHNIQ  
SVENDBORG BRAKES  
SEMCO MEETINGROOM  
DEE MEETINGROOM

# Find your graphic dimensions

## Page 11

LAUTEC  
WINDAR PHOTONICS  
ZITON  
AVAILABLE  
AVAILABLE  
DEE BAR / STORAGE

## Page 12

BSB INDUSTRY  
DEUGRO  
HOVE  
INTEGRATED WIND SOLUTIONS  
JUPITER BACH  
KK GROUP  
AVAILABLE  
(P) CBED  
(P) CREADIS  
(P) SM INDUSTRIES  
(P) VENTO MARITIME

## Page 13

FLEXTRIM / SAINT GOBAIN  
PRIMO OFFSHORE  
SKAGEN BLADE TECHNOLOGY

# Graphic Dimensions - 1

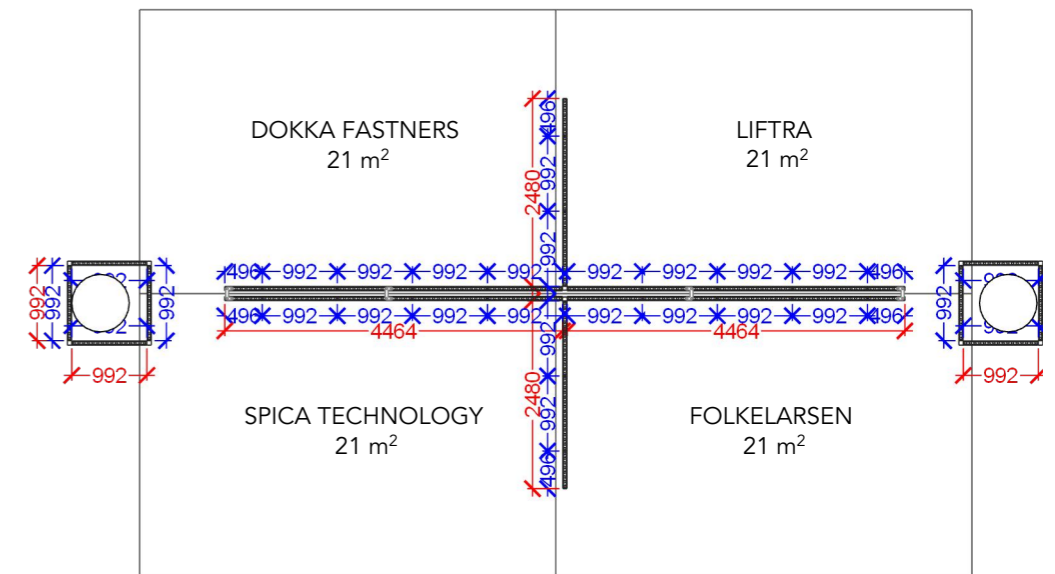
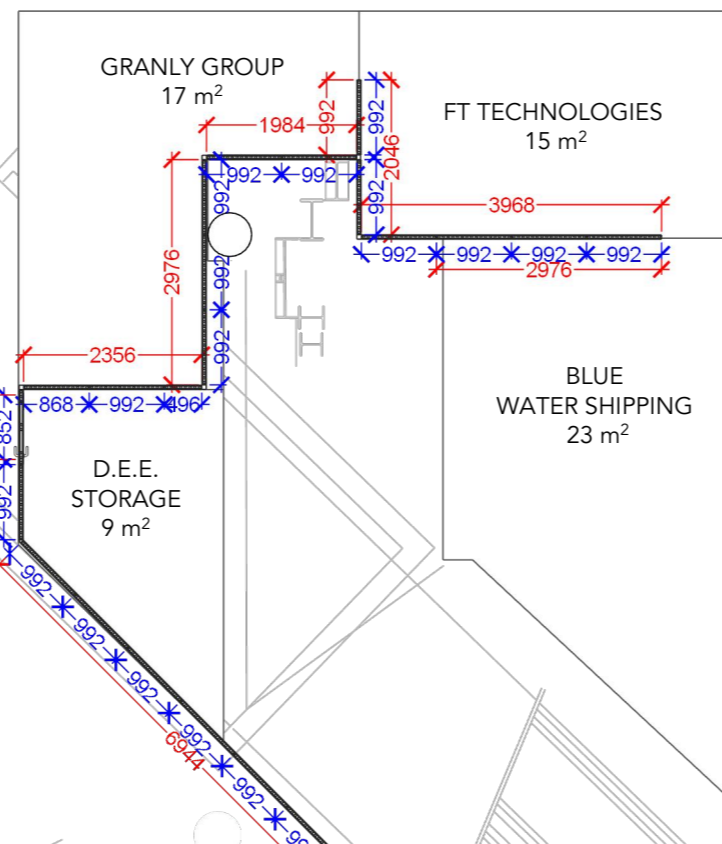
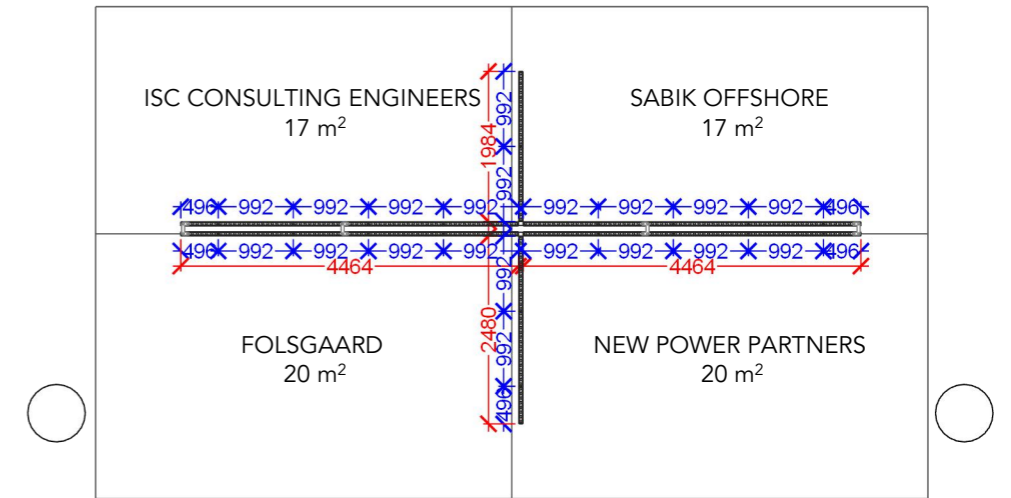
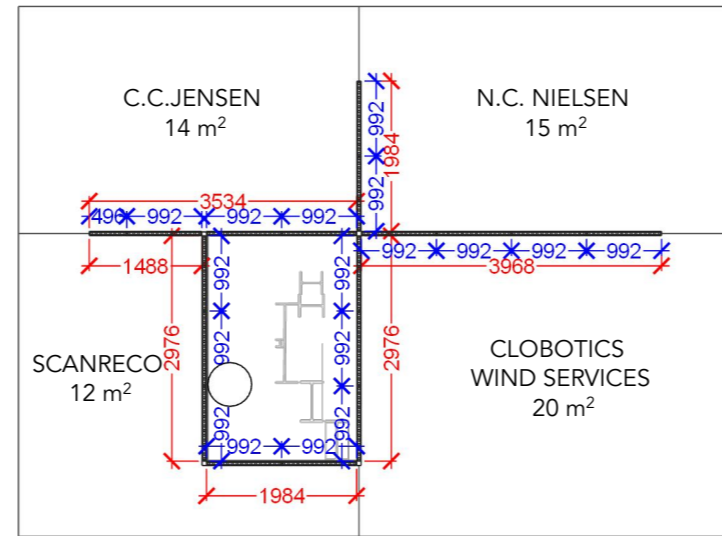
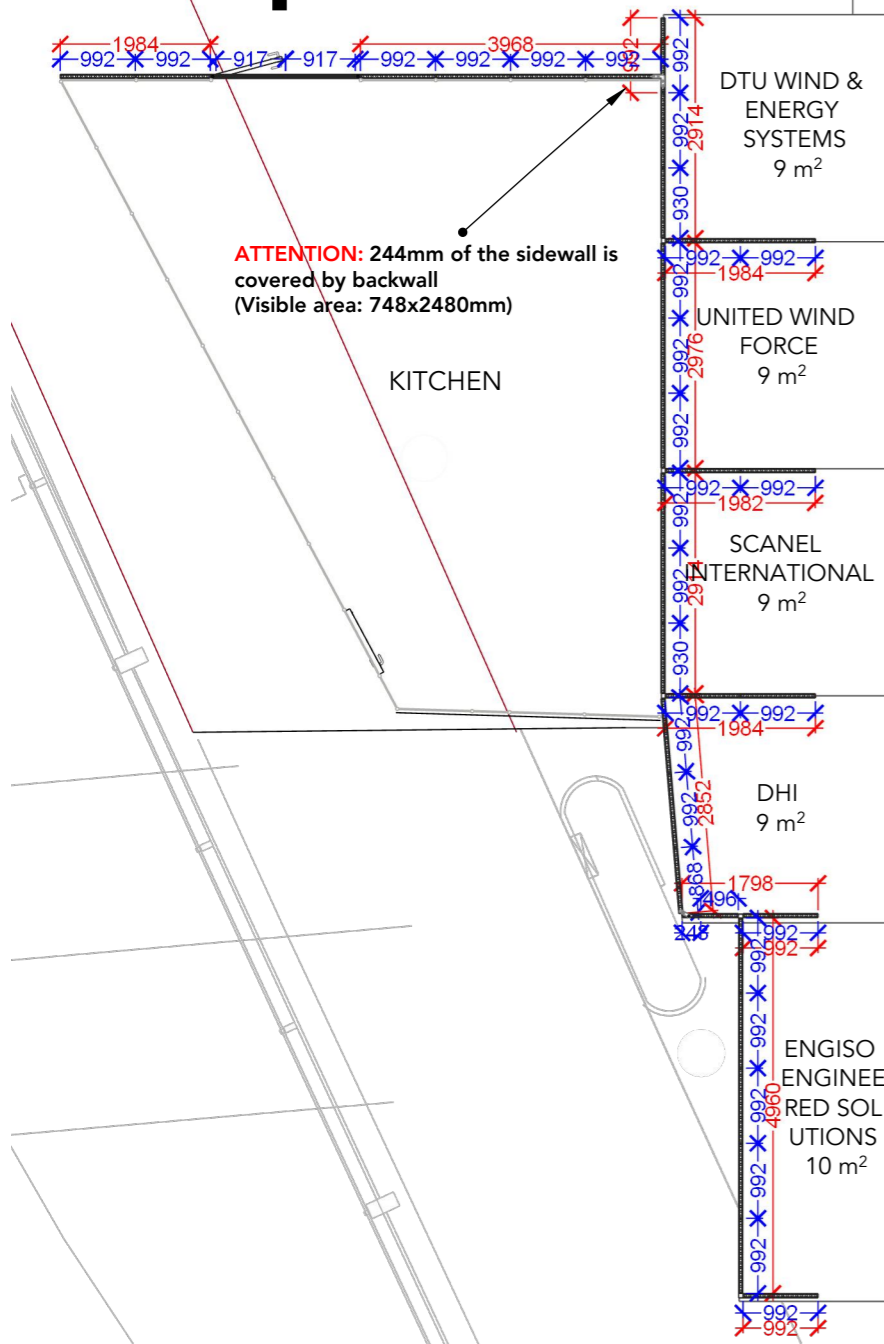

**WALL HEIGHT: 2480mm**  
**DOOR HEIGHT: 2398mm**  
**DOUBLE DOOR HEIGHT: 2393mm**

- Full size Fabric
- Single Frame Fabric

# Graphic Dimensions - 2

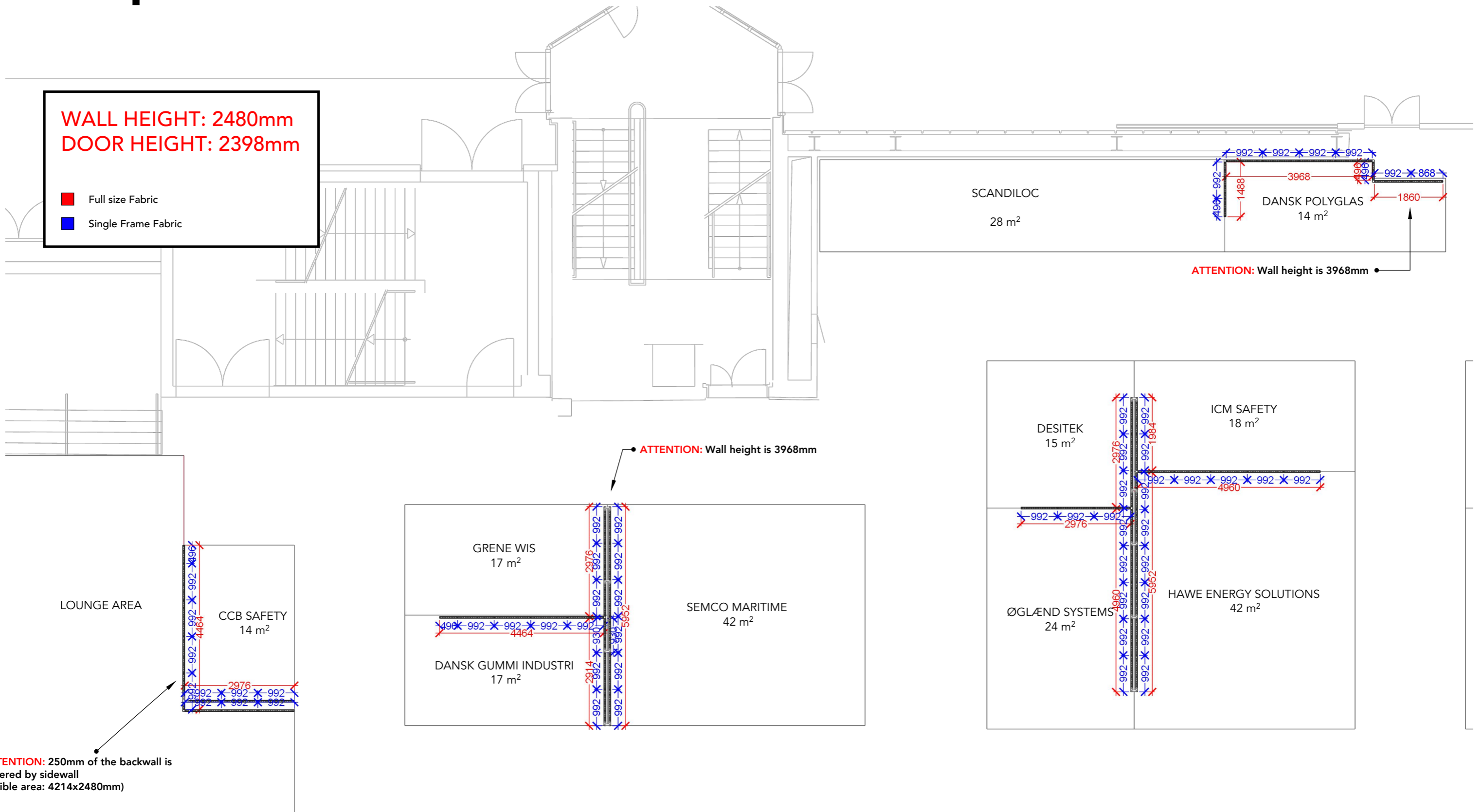

# Graphic Dimensions - 3

WALL HEIGHT: 2480mm  
DOOR HEIGHT: 2398mm

- Full size Fabric
- Single Frame Fabric

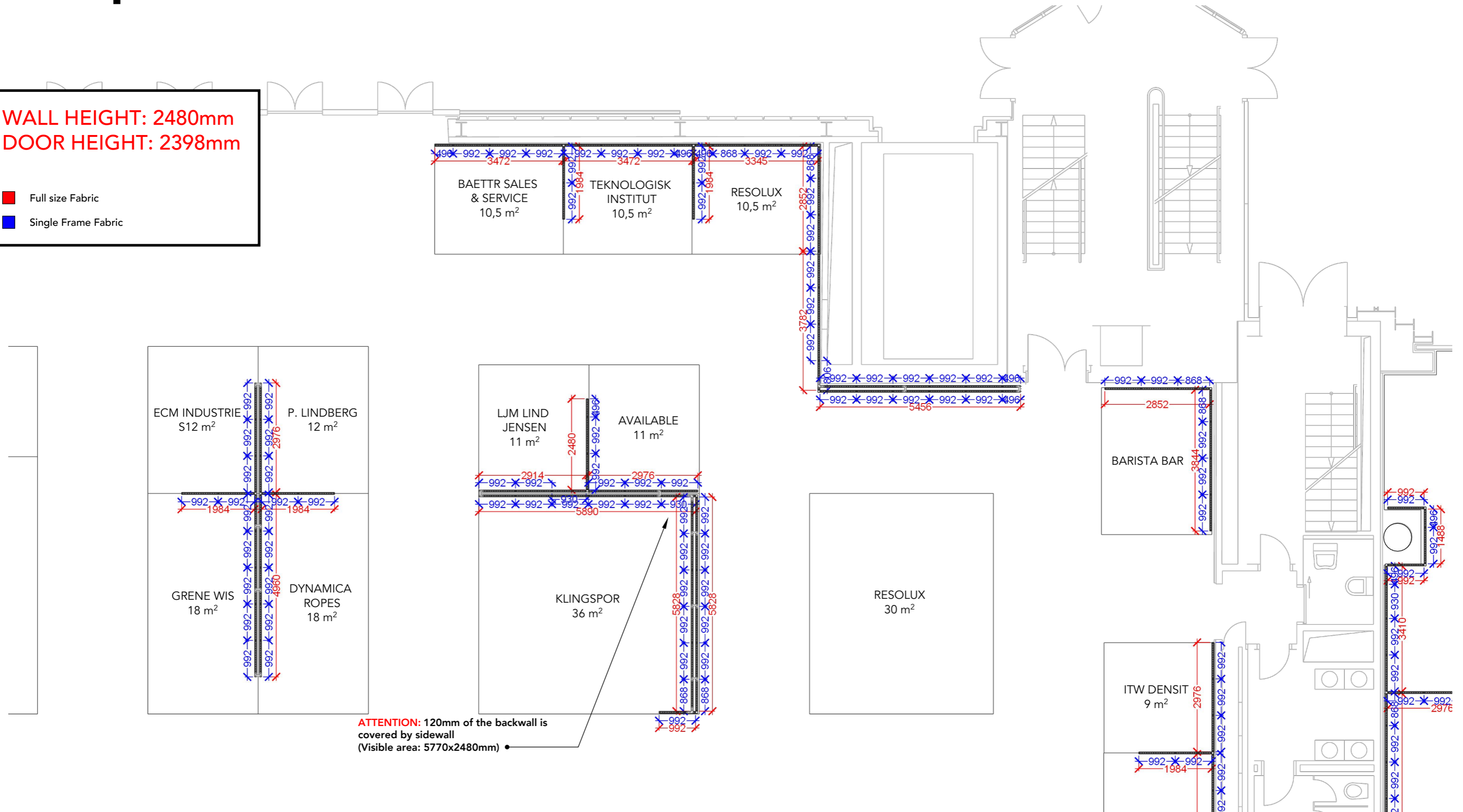

**ATTENTION:** 120mm of the backwall is covered by sidewall (Visible area: 5770x2480mm)

# Graphic Dimensions - 4

**WALL HEIGHT: 2480mm**  
**DOOR HEIGHT: 2398mm**

- Full size Fabric
- Single Frame Fabric

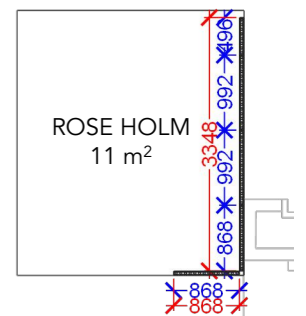
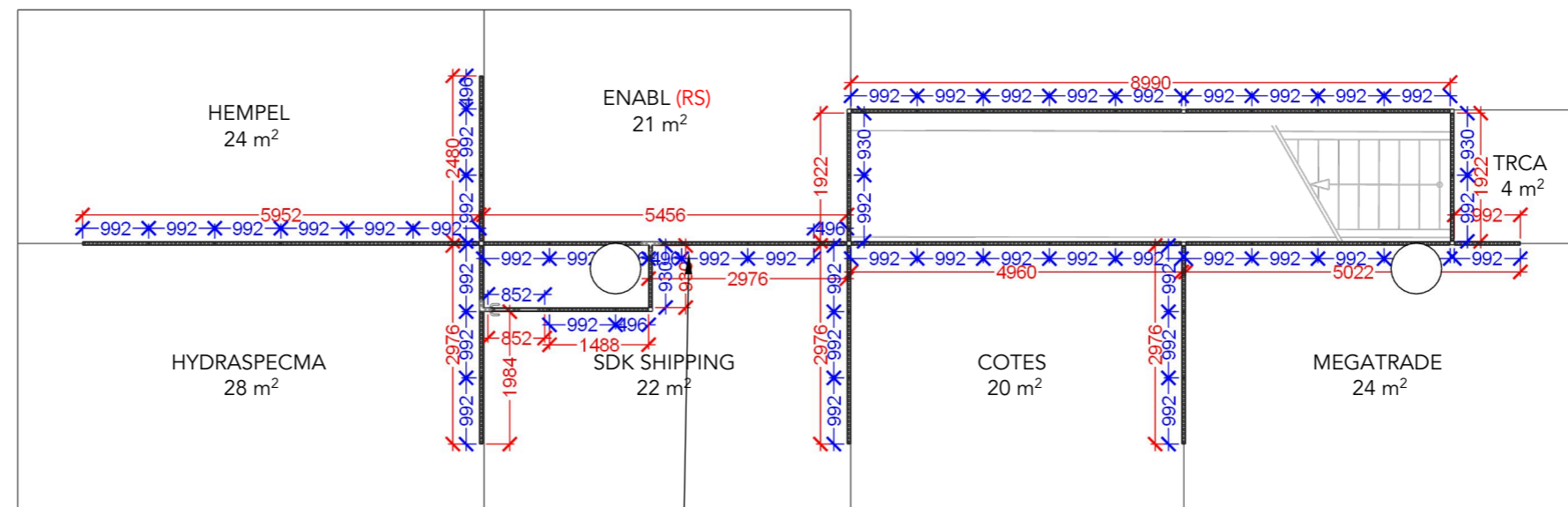
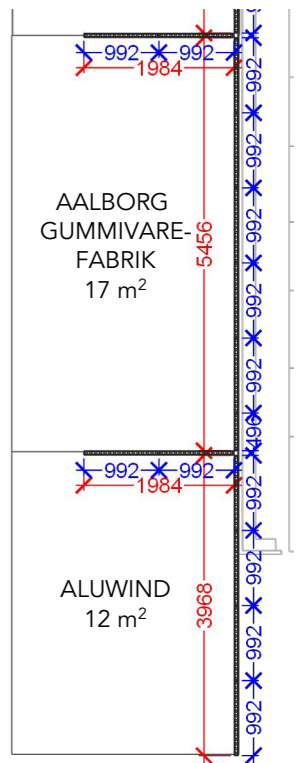
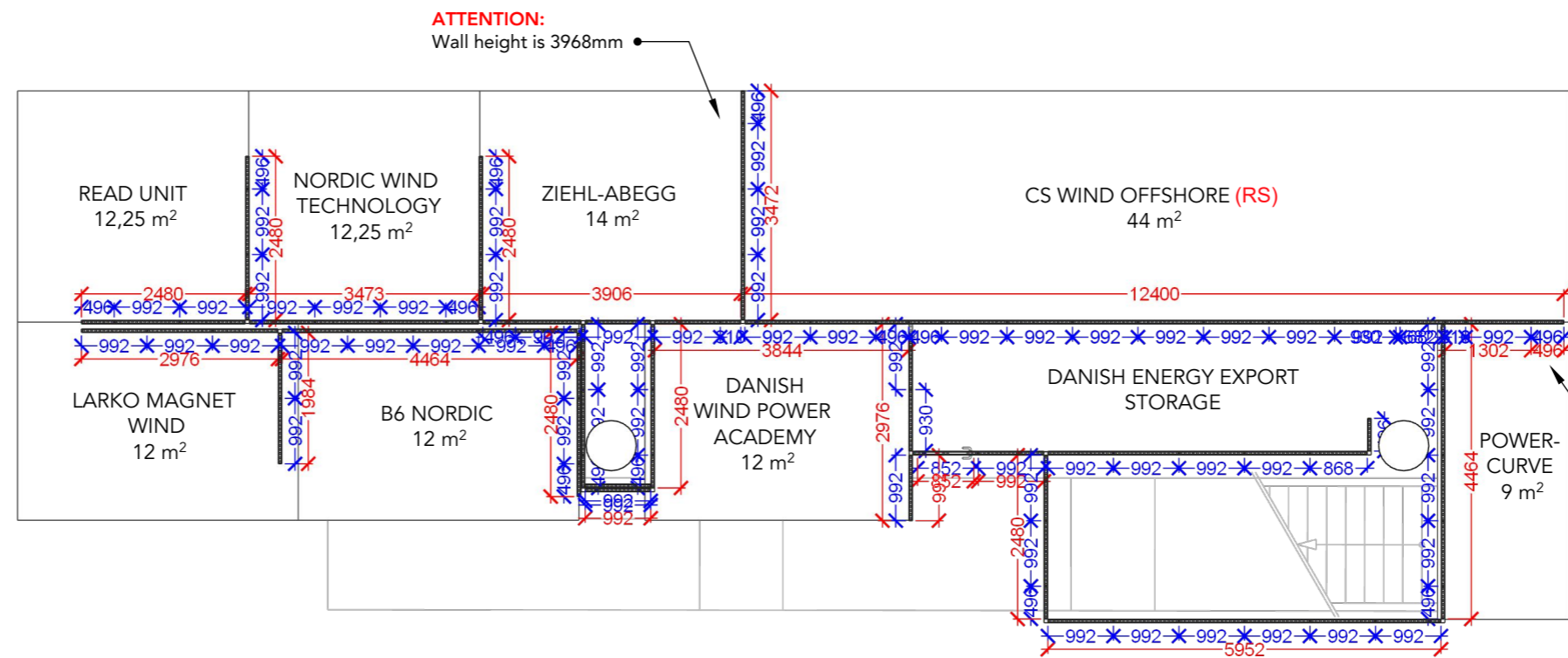

# Graphic Dimensions - 5

**WALL HEIGHT: 2480mm**  
**DOOR HEIGHT: 2398mm**

- Full size Fabric
- Single Frame Fabric

**ATTENTION:** Wall height is 3968mm

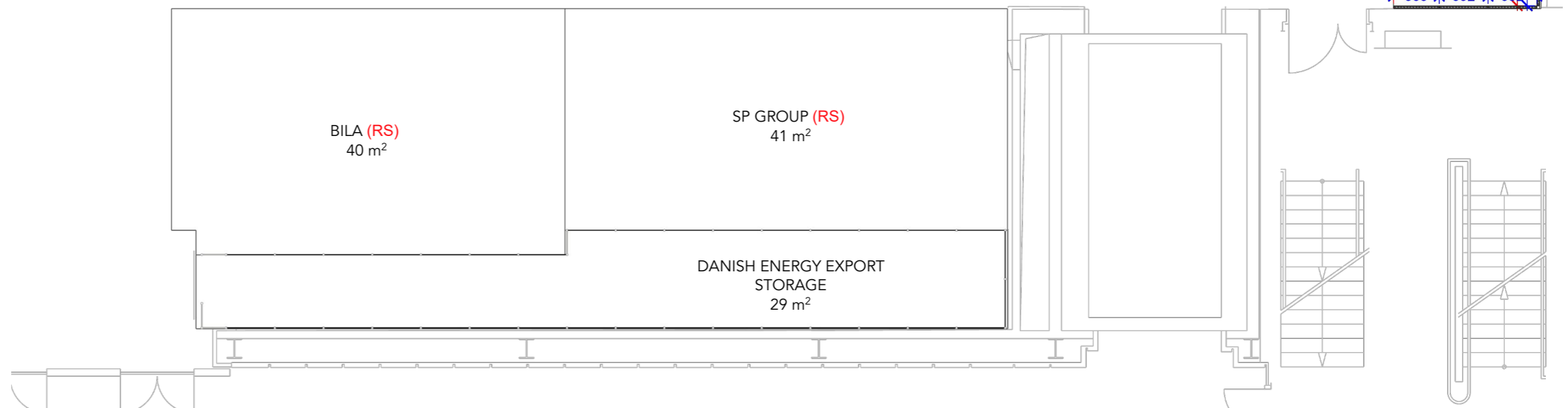
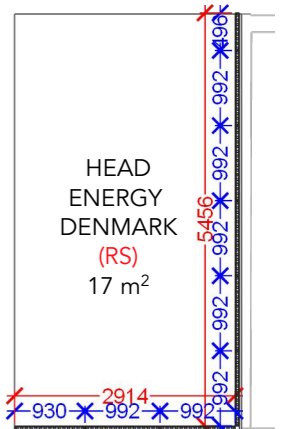
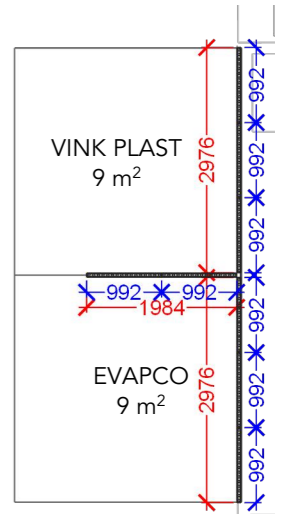
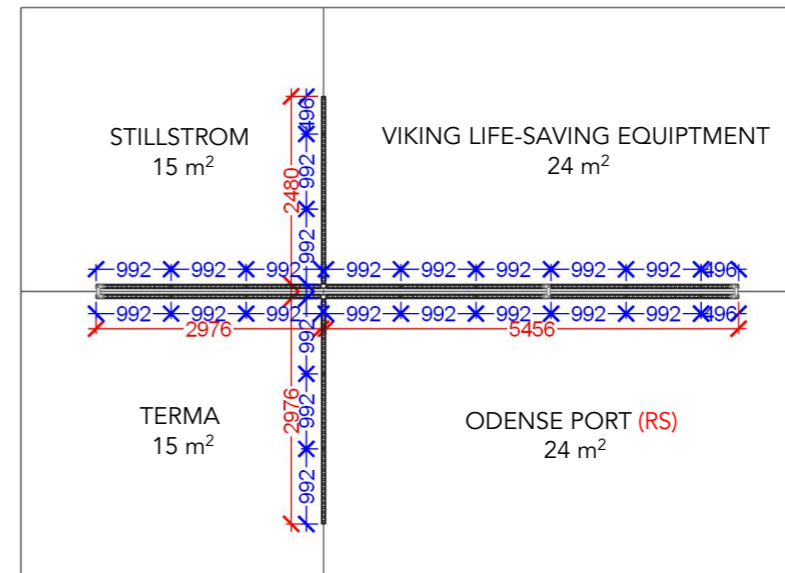
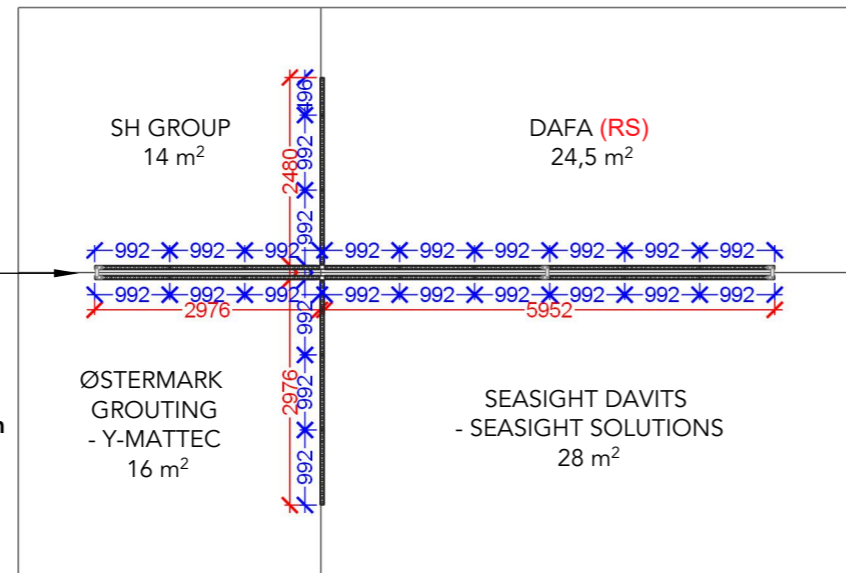

# Graphic Dimensions - 6

WALL HEIGHT: 2480mm  
DOOR HEIGHT: 2398mm

- Full size Fabric
- Single Frame Fabric

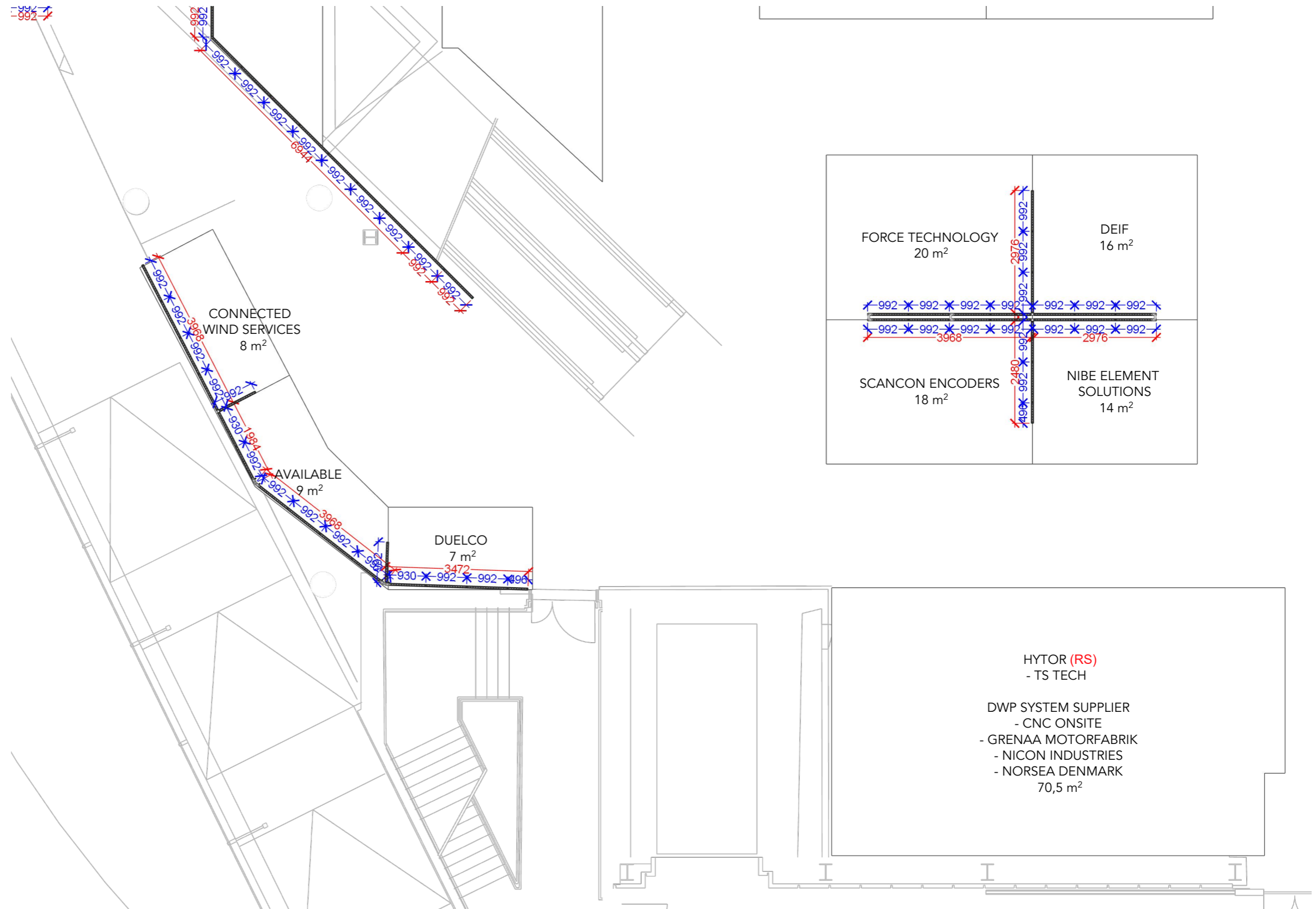

# Graphic Dimensions - 7

WALL HEIGHT: 2480mm  
DOOR HEIGHT: 2398mm

- Full size Fabric
- Single Frame Fabric

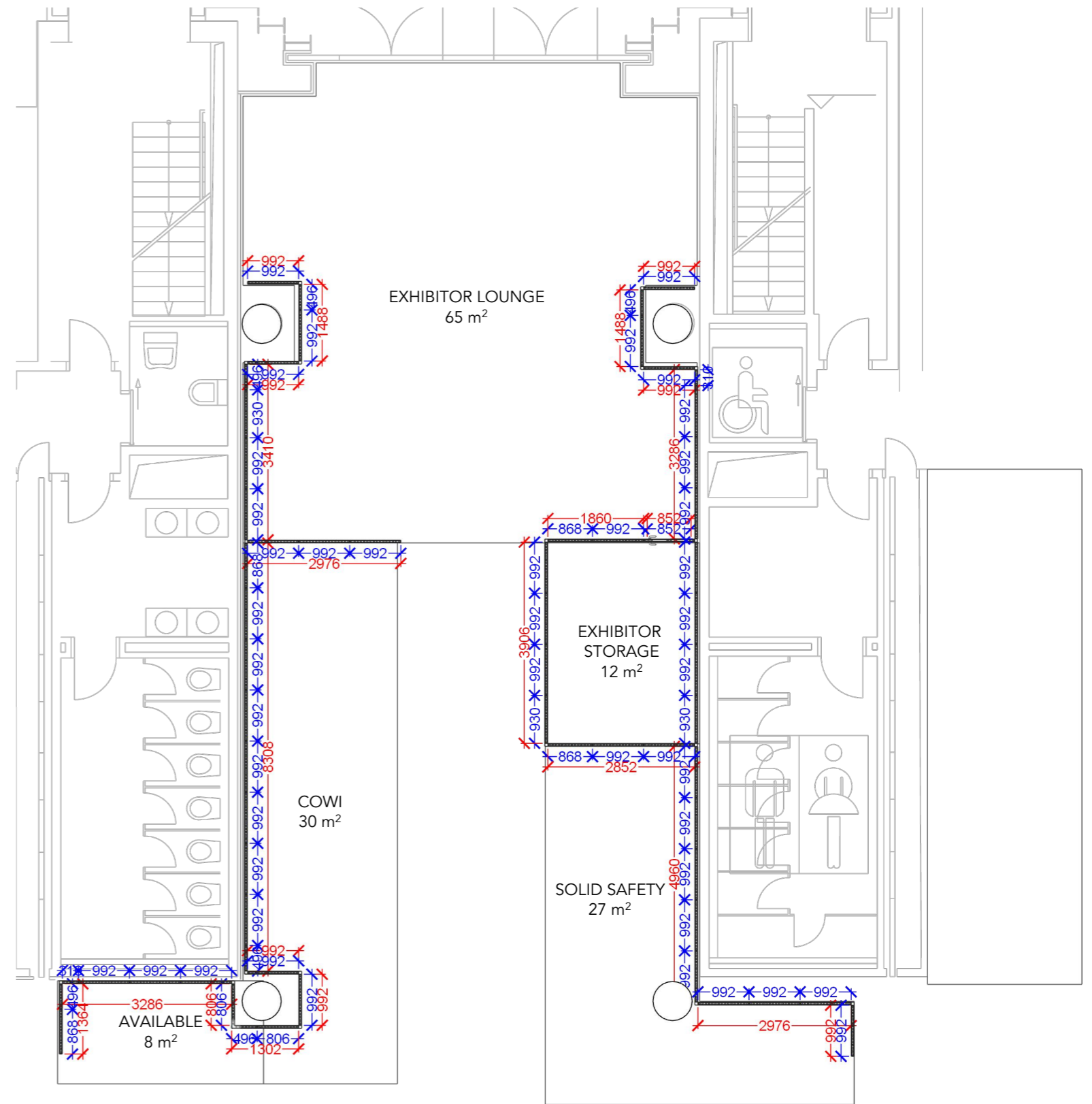

# Graphic Dimensions - 8

WALL HEIGHT: 2480mm  
DOOR HEIGHT: 2398mm

- Full size Fabric
- Single Frame Fabric

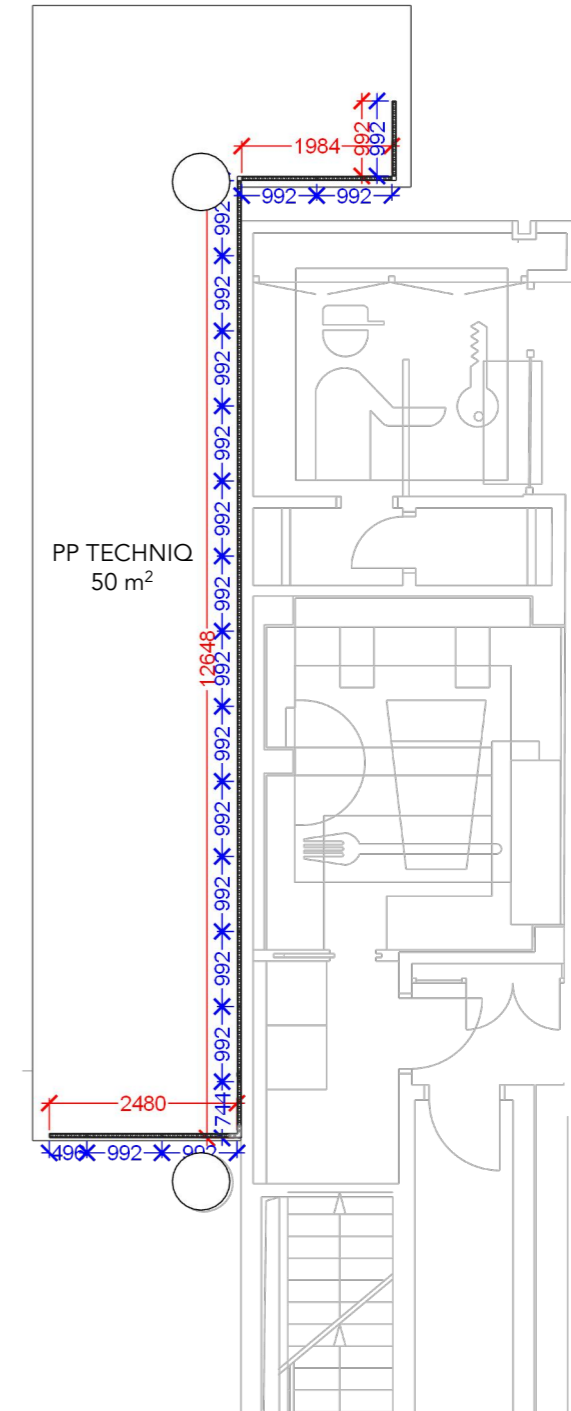
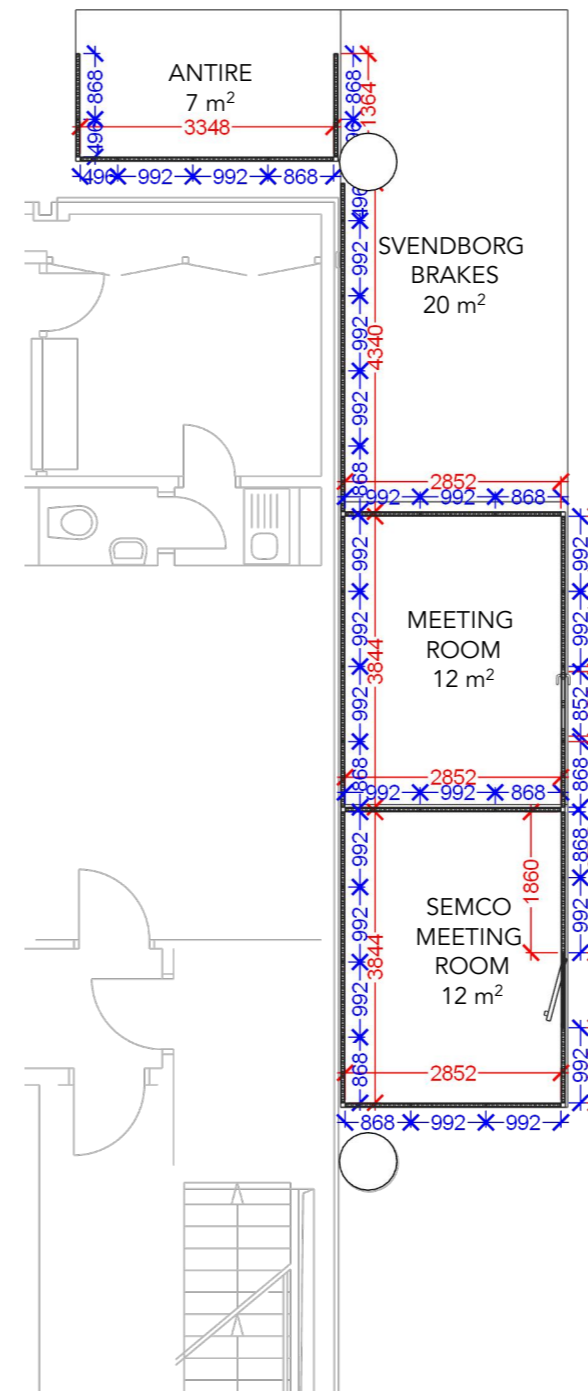

# Graphic Dimensions - 9

WALL HEIGHT: 2480mm  
DOOR HEIGHT: 2398mm

- Full size Fabric
- Single Frame Fabric

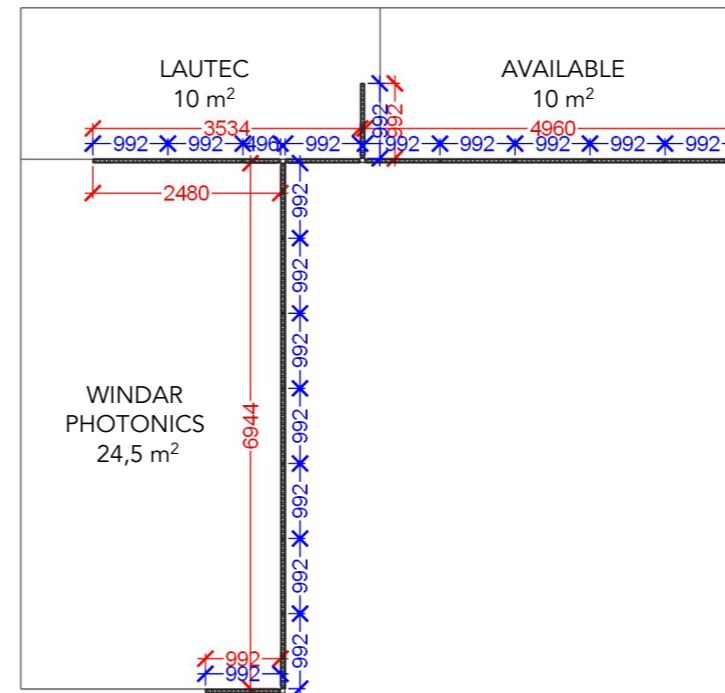
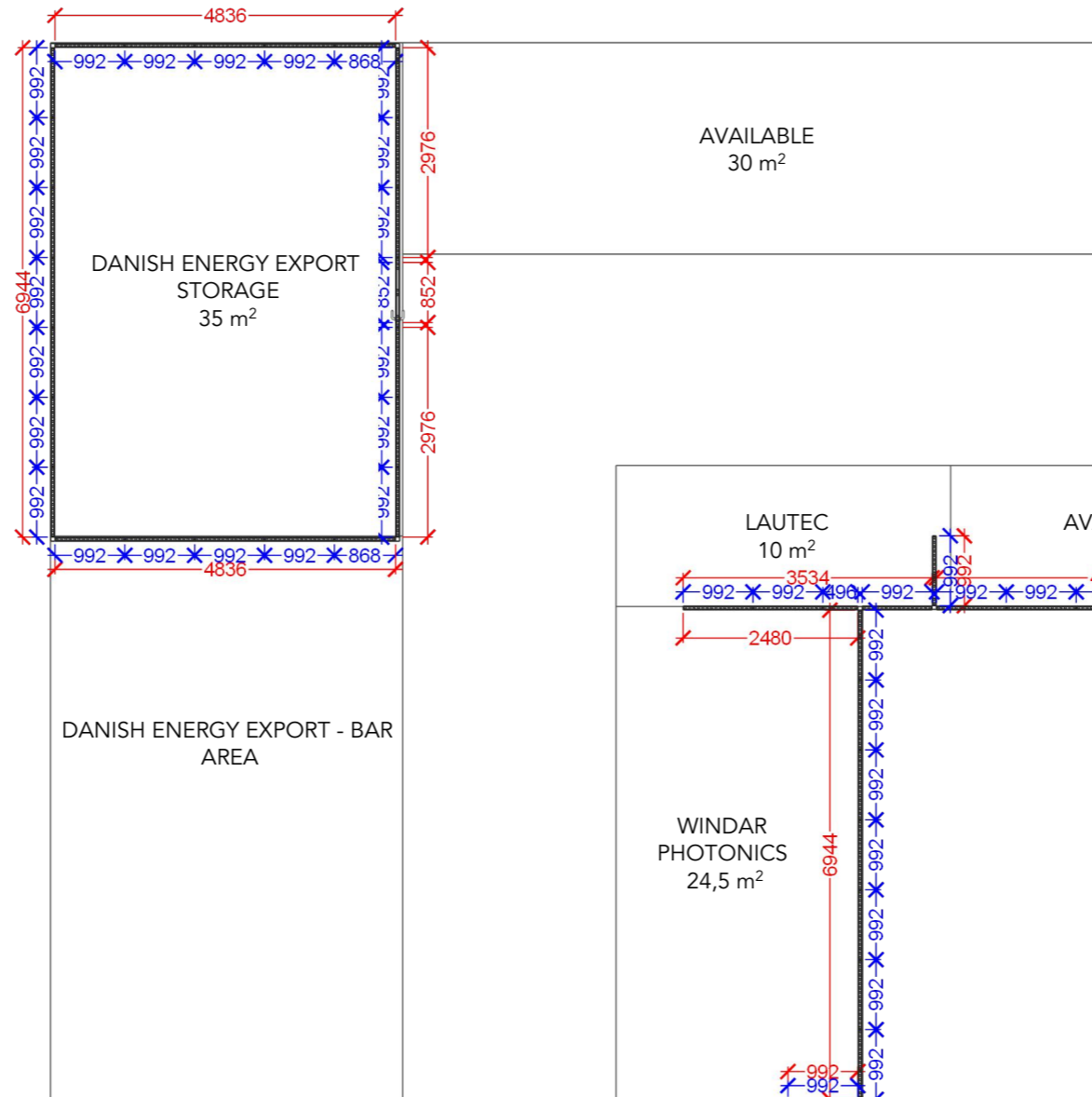
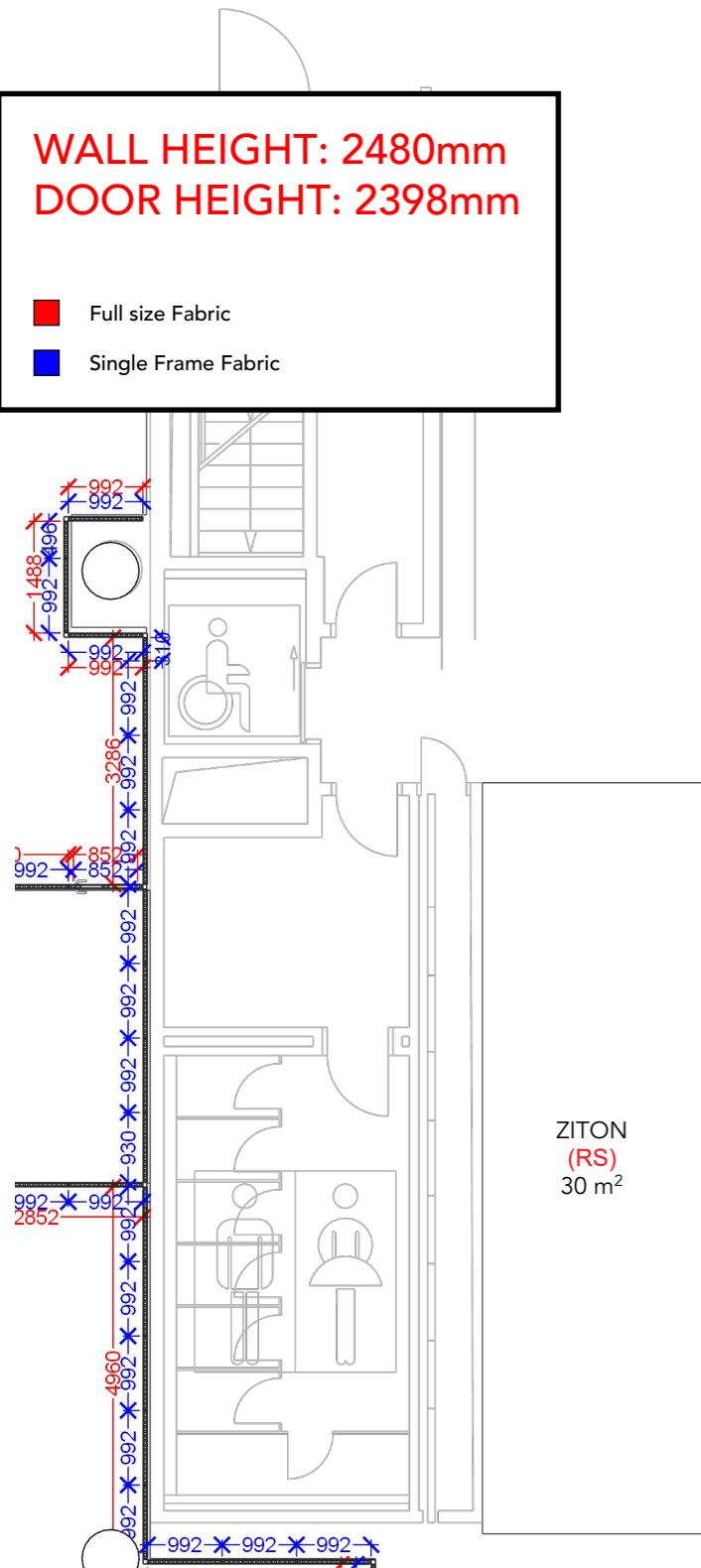

# Graphic Dimensions - 10

(P) VENTO MARITIME  
(P) SM INDUSTRIES

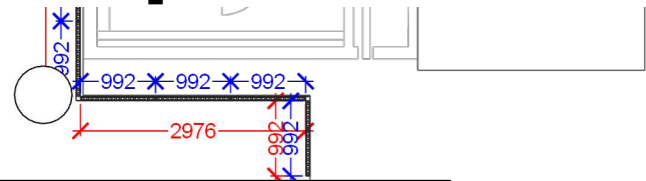

**WALL HEIGHT: 2480mm**  
**DOOR HEIGHT: 2398mm**

**POSTER SIZE:**  
**992x2480mm**

- Full size Fabric
- Single Frame Fabric

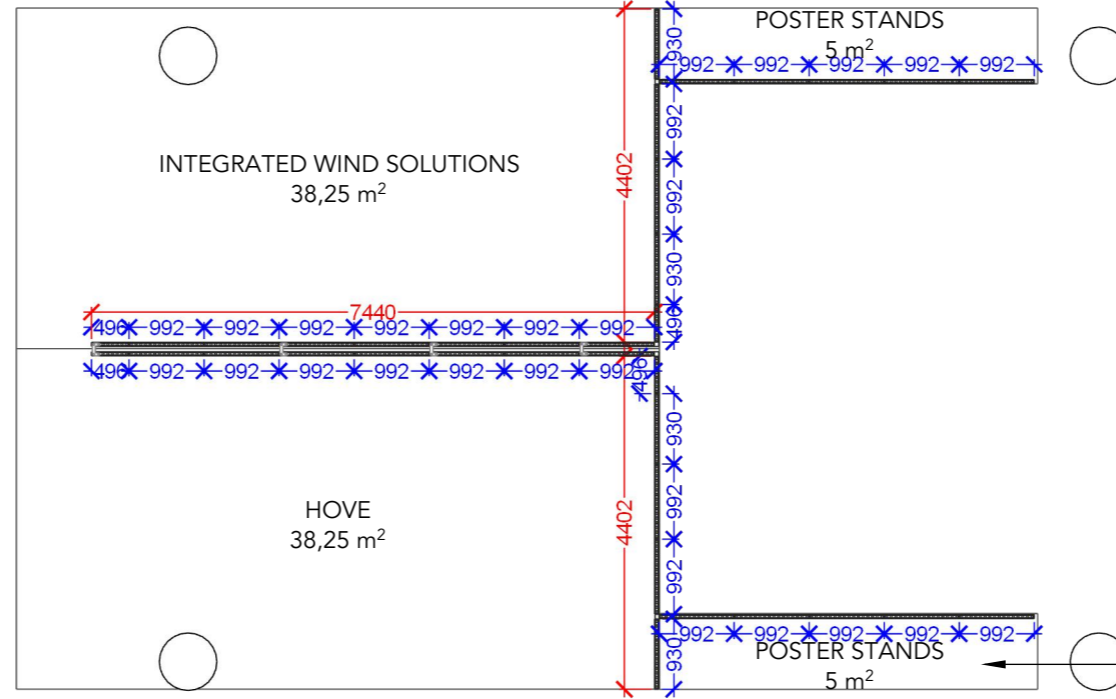

(P) CREADIS  
(P) CBED

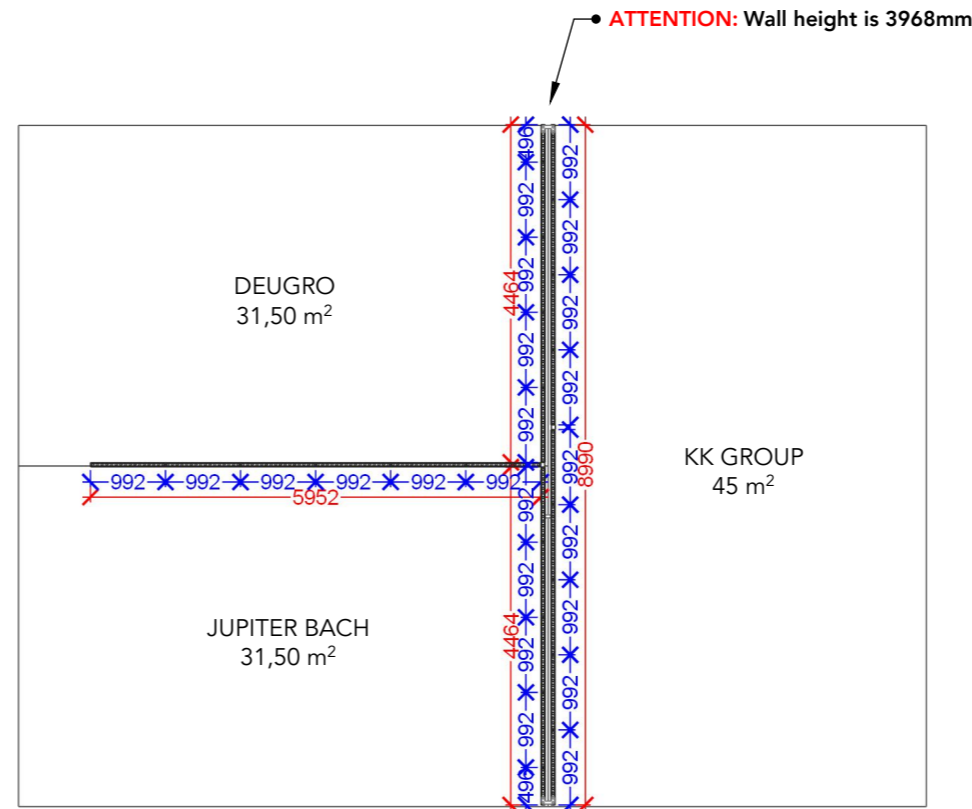
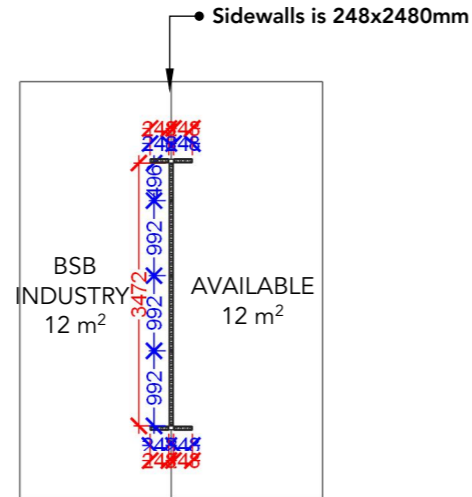
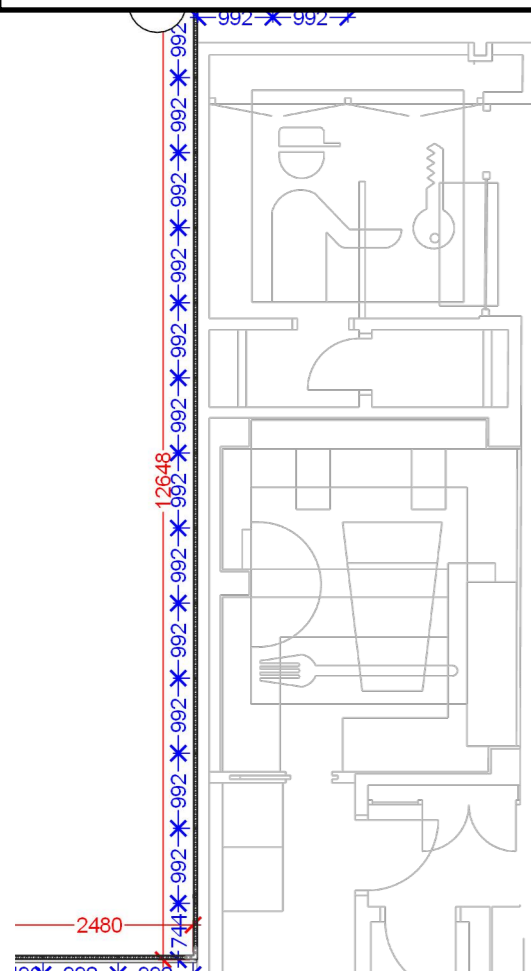

# Graphic Dimensions - 11

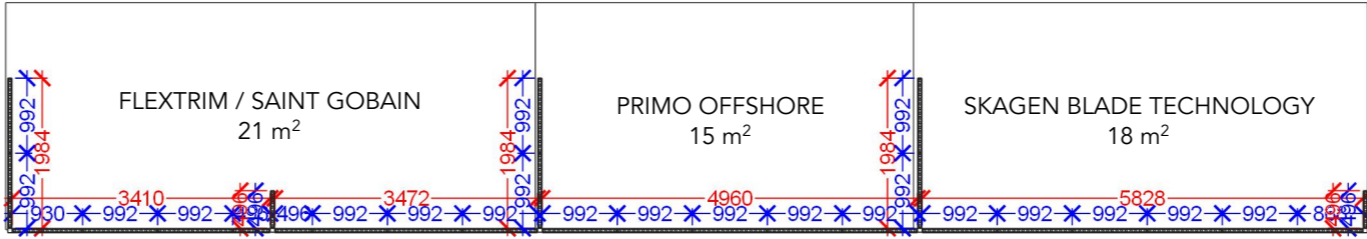
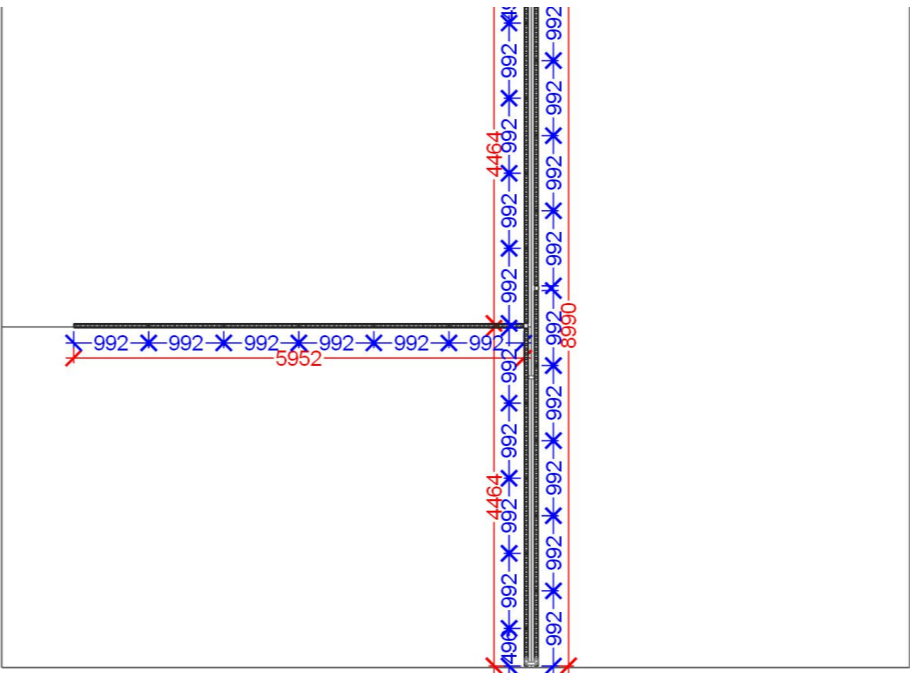
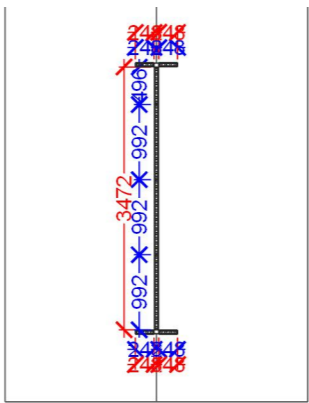
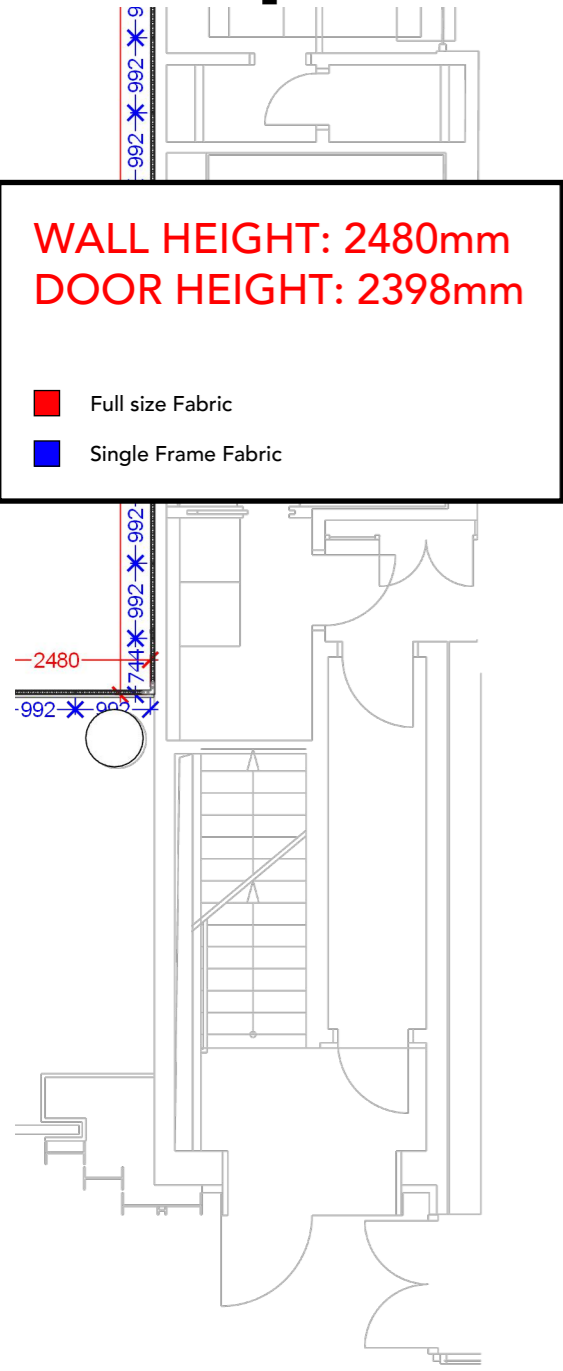

# Info

Client: Danish Energy Export  
Exhibition: WindEnergy Hamburg 2026

Project no.: EXP-WEN-26-09  
Designed By: TJ  
Hall: B1.EG + B2.EG  
Booth: Multi.

Creation Date: 10.03.2026  
Revision Date: 22.05.2026  
Revision no.: 03

Comments:

The drawing is indicative and without responsibility. The drawing is NOT to scale. The stand-builder will have the final call in all decisions regarding stability and security. Some products are only shown to indicate locations, but not the actual product as this product may be changed.  
All design is subject to copyright by Compass Fairs A/S and Standesign A/S

